

## 1KV Insulation Piercing Connector



Type	Main Line Section (mm <sup>2</sup> )	Branch Line Section (mm <sup>2</sup> )	Torque(Nm)	Nominal Current(A)	Bolt(mm)
KW101-CT	1.5-25	1.5-10	10	55	M6*1
KWEP-CT	16-95	1.5-16	10	65	M6*1
KW101	16-25	1.5-10	10	55	M6*1
KWEP	16-95	1.5-16	10	65	M6*1
KW4-35	4-35	4-35	7	120	M6*1
KW102	6-50	4-25	15	102	M8*1
KW2-95	16-95	4-50	20	157	M8*1
KW2-150	50-150	6-50	20	157	M8*1
KW-150/10	10-150	1.5-10	15	55	M8*1
KW95/50	16-95	4-50	12	157	M6*1
KW3-95	25-95	25-95	20	214	M8*1
KW4-150	35-150	35-150	26	316	M8*1
KW6	120-240	10-120	35	276	M10*1
KWEP-BT	16-95	1.5-16	10	65	M6*1
KW2-150BT	16-150	4-50	15	157	M8*1
CTH35	16-95	4-50	15	157	M8*1

## 1KV Insulation Piercing Connector



Type	Main Line Section (mm <sup>2</sup> )	Branch Line Section (mm <sup>2</sup> )	Torque(Nm)	Nominal Current(A)	Bolt(mm)
KW240	50-240	50-240	32	425	M8*2
KW10-70A	16-95	4-50	18	157	M8*2
KW-150/150ST-B	35-150	35-150	26	316	M8*2
KW-150/35	50-150	4-50	18	157	M8*2

## 1KV Insulation Piercing Connector



Type	Main Line Section (mm <sup>2</sup> )	Branch Line Section (mm <sup>2</sup> )
JBC-1	35-70	6-35
JBC-2	35-120	35-120
JBC-3	50-240	50-240
CPL-1	16-95	16-25
CPL-2	35-120	35-120

## 1KV Insulation Piercing Connector for Bare Cable



Type	Main Line Section (mm <sup>2</sup> )	Branch Line Section (mm <sup>2</sup> )	Torque(Nm)	Nominal Current(A)	Bolt(mm)
KW2-95L	16-95(Bare Cable)	4-50	15	157	M8*1
KW2-150L	16-150(Bare Cable)	4-50	15	157	M8*1
KW4-150L	16-150(Bare Cable)	16-150	20	276	M8*1
KW2-150BT-L	16-150(Bare Cable)	4-50	12	157	M8*1
CTH35L	16-95(Bare Cable)	4-50	15	157	M8*1
CTH95L	6-120(Bare Cable)	25-95	25	214	M10*1

## CD Series IPC



Type	Main Line Section (mm <sup>2</sup> )	Branch Line Section (mm <sup>2</sup> )	Torque(Nm)	Nominal Current(A)	Bolt(mm)
CD21	10-35	2.5-35	15	120	M10*1
CD71	35-95	4-70	18	180	M10*1
CD72	35-95	2x4-70	18	180	M10*2
CT295-2	35-95	2.5-35	/	120	M10*2
CT295-3	35-95	2*2.5-35	/	120	M10*3

## TTD Series 1KV Insulation Piercing Connector

Insulation piercing connector property: It is mainly used for branch connection, and grounding protection for 1KV, 10KV and 20KV.

1. Simple installation: Put the main wire and the branch wire directly on the right place without wire stripping. Tighten the shear head evenly by wrench.
2. Low resistance and low temperature-rise: The special bolts can ensure equal piercing pressure for superior electric contact and less wire damage, so that make sure the normal service life of the pierced wire.
3. Sealing structure with good insulation: tight insulated lining and enough compound to ensure the insulation function in good control when connector used outdoors.



Type	Main Line (mm <sup>2</sup> )	Branch Line (mm <sup>2</sup> )	Max Current (A)	Bolt		Torque Nut
				Quantity	H(mm)	
TTD041FJ	6-35	1.5-10	86	M8*1	13	F1309
TTD051FJ	16-95	1.5-10	86	M8*1	13	F1309
TTD101FJ	6-50	2.5(6)-35	200	M8*1	13	F1314
TTD151FJ	25-95	2.5(6)-35	200	M8*1	13	F1314
TTD201FJ	35-95	25-95	377	M8*1	13	F1318
TTD251FJ	50-150	25-95	377	M8*1	13	F1318
TTD271FJ	35-120	35-120	377	M8*1	13	F1318
TTD281FJ	50-185	2.5(6)-35	200	M8*1	13	F1314
TTD301FJ	25-95	25-95	377	M8*2	13	F1314
TTD401FJ	50-185	50-150	504	M8*2	13	F1318
TTD431FJ	70-240	16-95	377	M10*2	17	F1720
TTD441FJ	95-240	50-150	504	M10*2	17	F1725
TTD451FJ	95-240	95-240	530	M10*2	17	F1725
TTD551FJ	120-400	95-240	679	M10*2	17	F1737

## 1KV 4 Core Insulation Piercing Connector



Type	Main Line Section (mm <sup>2</sup> )	Branch Line Section (mm <sup>2</sup> )	Torque(Nm)	Nominal Current(A)	Bolt(mm)
GHFC-1	70~95(Sector)	6~50(Sector)	/	157	M8*2
	50~95(Round)	6~70(Round)			
GHFC-2	95~150(Sector)	6~50(Sector)	/	157	M8*2
	70~150(Round)	6~70(Round)			
GHFC-3	95~150(Sector)	6~150(Sector)	/	316	M8*2
	95~150(Round)	6~150(Round)			
GHFC-4	185~240(Sector)	6~50(Sector)	/	157	M10*2
	185~240(Round)	6~70(Round)			

## Installation Insulation Piercing Connector

- 
1. Adjust the connector nut to suitable location.
  2. Put the branch wire in to the cap sheath fully.
  3. Insert the main wire, if there are two lays of insulated lay in the main cable, should strip a certain length of the first insulated lay from inserted end.
  4. Turn the nut by hand, and fix the connector in suitable location.
  5. Screw the nut with the sleeve spanner.
  6. Screw the nut continually until the top part is cracked and dropped down.

## Performance Testing

1. Mechanical performance: the grip force of the wire clamp is 1/10 bigger than the break force of the lead, it complys with EN50483.
2. Temperature rise performance: under the condition of big current, the temperature rise of connector is less than that of connection lead.
3. Heat circle performance: conforms to GB/T2317.3-2000, the heat circle trial standard for electric fitting.
4. Waterproof insulation performance: conforms to the relevant testing requirements in part 2 of GB/T13140.4-1998.
5. Resistance to corrosion performance: under the condition of acid and salt fog, it can do three times of fourteen days circle testing.
6. Environmental aging performance: under the circumstance of ultraviolet, radiation, dry and moist, expose it with change of temperature and heat impulse for six weeks.
7. Fire-proof performance: insulation material of the connector withstands glowing filament test. Conform to the requirement in chapter 4-10 of GB/T5169.4



## Plastic Tension Clamp

The tension clamp is designed for service line with 1 conductor.

- Clamp body is made of high mechanical strength and weather resistant insulation material.
- Special designed clip is used to prevent the bail slipping from the body. Tool free installation.
- Standard: NFC33-042



PA16



PA16~95 PA4-20N

Type	Cross-section (mm <sup>2</sup> )	Messenger DIA.(mm)	Breaking Load (kN)
PA16	10-70	6-13	3
PA16~95	4-120	4-16	2.5
PA4-20N	4-185	4-20	2.5

## Plastic Tension Clamp

- Clamp body is made of high mechanical strength and weather resistant insulation material.
- Special designed clip is used to prevent the bail slipping from the body.
- Standard: NFC33-042



PA25



PA1500

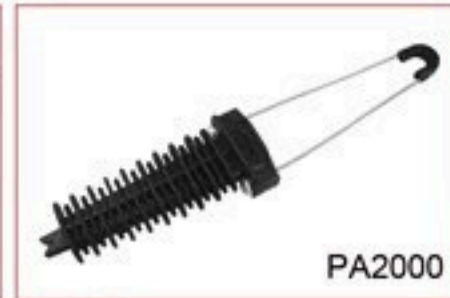

PA2000

Type	Cross-section (mm <sup>2</sup> )	Messenger DIA.(mm)	Breaking Load (kN)
PA25	6-25	4-9	2.5/4
PA1500	50-70	11.2-12.8	6
PA2000	70-95	12.8-14.8	8

## Plastic Tension Clamp

- Standard: NFC33-042



PA4/6~35P

Type	Cross-section (mm <sup>2</sup> )	Breaking Load (kN)
PA4/6~35P	4x16-35	2.5

## Plastic Tension Clamp

The tension clamp is designed for service line with 2 or 4 conductors.

- Clamp body is made of high mechanical strength and weather resistant insulation material.
- Standard: NFC33-042



PA2/25



PA4/25 PA4/50

Type	Cross-section (mm <sup>2</sup> )	Breaking Load (kN)
PA2/25	2x10-35	2.5
PA4/25	4x16-25	2.5
PA4/50	4x16-50	2.5

## Plastic Tension Clamp

The tension clamp is designed for LV ABC Cables.

- Standard: NFC33-042



PA-903



PA25S



PA435A

Type	Cross-section (mm <sup>2</sup> )	Breaking Load (kN)
PA-903	25-70 / 2x10-25	1.5
PA25S	4x16-25	2.5
PA435A	4x16-35	2.5

## Plastic Tension Clamp

- Standard: NFC33-042



PA-901

Type	Cross-section (mm <sup>2</sup> )	Breaking Load (kN)
PA-901	4x10-25	3

## PAL Metal Tension Clamp

The tension clamp are used to anchor and tighten LV-ABC lines with insulated neutral messenger. These clamps are easy to install without tools and suitable for various climatic conditions.

Standard: NFC33-041, EN50483-3



PAL1500

Type	Cross-section (mm <sup>2</sup> )	Messenger DIA.(mm)	Breaking Load (KN)
PAL1000A	10-35	5-9.8	10
PAL1000	25-50	8-12	12
PAL1500	35-70	10-13	15
PAL2000	70-150	13-18.5	18
PAL2000S	70-120	13-16	15

## PAL Metal Tension Clamp

The PAL tension clamp is used to anchor and tighten LV-ABC lines with insulated neutral messenger.



Type	Cross-section (mm <sup>2</sup> )	Messenger DIA.(mm)	Breaking Load (KN)
JBG-50-1000	25-50	8.4-11.2	10
JBG-70-1000	50-70	11.2-12.8	10

## PA Metal Tension Clamp

The PA tension clamp is designed for service line with 2 or 4 conductors.



PA2/35

PA4/35

Type	Cross-section (mm <sup>2</sup> )	Messenger DIA.(mm)	Breaking Load (KN)
PA2/35	2x16-35	7-10	5
PA4/35	4x16-35	7-10	7

## Metal Tension Clamp

The tension clamp is designed for service line with 2 or 4 conductors.



PA4/16~35



KW160



KW161

Type	Cross-section (mm <sup>2</sup> )	Messenger DIA.(mm)	Breaking Load (KN)
PA4/16 ~ 35	4x16-35	7-10	12
KW160	2x16-35	7-10	5
KW161	4x16-35	7-10	5

## RPA,NES Metal Tension Clamp

The tension clamp is designed for service line with 4 conductors.



RPA425/70



NES-1S



NES-2S

Type	Cross-section (mm <sup>2</sup> )	Messenger DIA.(mm)	Breaking Load (KN)
RPA425/70	4x16-50	7-11	20
RPA450/120	4x50-120	11-16	20
NES-1S	4x16-50	7-11	20
NES-2S	4x50-120	11-16	20

## NLL, Tension Clamp

NLL series aluminum alloy strain clamp (Bolt type) is suitable for aerial line up to 35KV, fixing aluminum wire or steel core minium wire on the strain pole, aerial insulation aluminum conductor and insulation aluminum cover are being used together action is insulation protection.

### Structure Feature

- The body is made of hith-strength aluminum alloy
- Smooth surface long servile life
- Easy installation
- No waste electric energy



Type	Cable Diameter (mm)	Breaking Load (kN)	U Bolt Qty
NLL-1B	5.0-15.5	60	2
NLL-2B	5.1-20.5	60	2
NLL-3B	11.4-22.6	80	3
NLL-4D	13-26.4	90	3



Type	Cable Diameter (mm)	Breaking Load (kN)	U Bolt Qty
NLL-10	3~8.5	10	1
NLL-20	3~15	30	2

## NXJ, Tension Clamp

NXJ series is suitable for strain clamp 10KV or below JKLYJ wire.

### Structure Feature

- The body is made of hith-strength aluminum alloy
- Smooth surface long servile life
- Easy installation
- No waste electric energy



### NXJG Wedge Clamp

Model	Applicable wire nominal cross-section (mm)	Main dimensions(mm)							Nominal breaking load(kN)	Reference Quality (KGS)
		L	L1	L2	B	H	C	M		
NXJG-1	35~50	290	112	138	70	29	18	14	7.4	0.8
NXJG-2	70~95	315	135	175	84	29	18	14	14.5	1
NXJG-3	120~150	400	146	170	100	30	18	14	22.1	1.6
NXJG-4	185~240	400	150	180	105	35	18	16	36.4	1.8

### NXJL Wedge Clamp

Model	Applicable wire nominal cross-section (mm)	Main dimensions(mm)					Nominal Breaking Load(kN)	Reference Quality (KGS)
		L	L1	L2	L3	M		
NXJL-1	35~50	272	110	33	138	8	10.8	0.6
NXJL-2	70~95	325	133	35	175	10	18.2	1
NXJL-3	120~150	362	143	38	170	12	22.1	1.5

## NXL, TENSION CLAMP

NXL Series strain clamp is suitable for distribution wire up to 10kV, fixing the aerial insulation aluminum conductor or naked aluminum conductor on the rotate angle or insulator of terminal strain pole, and then fixing and tightening the aerial conductor.



### Structure Feature

- Choose the unmagnetic character high-intensity oxidate-resistance aluminum alloy, No waste electric energy.
- Wedge-Locked structure, easy installation.
- An are embrace the most part, conductor can't change. Large grip strength.



### Insulation Cover Performance Feature

- Withstand voltage:  $\geq 18\text{kV}$  keep voltage one minute not breakdown
- Insulation resistance:  $> 1.0 \times 10^{14} \Omega$
- Environmental temperature:  $-30^\circ\text{C}$  to  $90^\circ\text{C}$

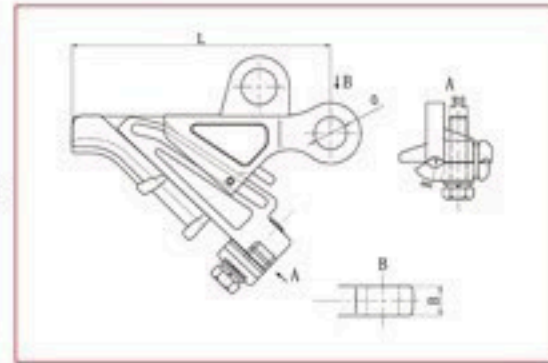

Model	Applicable wire cross-section area (mm <sup>2</sup> )	Reference stripping length (mm)	Main dimensions (mm)				Grip (KN)	Nominal breaking load (KN)	Reference Quality (KGS)
			L	Φ	R	B			
NXL-1	35~50	225	145	18	5	16	4.6	7.4	1.2
NXL-2	70~95	245	155	18	6	16	9	14.5	1.3
NXL-3	120~150	255	165	18	8.5	16	13.7	22.1	1.5
NXL-4	185~240	300	190	18	11	16	22.6	36.4	2

## NUT Type Clamp (Adjustable)

Clamp body and wedge are cast iron, others are steel, all are hot galvanized.

Type	Steel Wire Dia (mm)	Dimensions (mm)				Rated failure load (kN)
		C	M	L	L1	
NUT-1	6.6~7.8	56	16	350	200	45
NUT-2	9.1~11.0	62	18	430	250	88
NUT-3	13.0~14.0	74	22	500	300	143
NUT-4	15.0~16.0	82	24	580	300	164

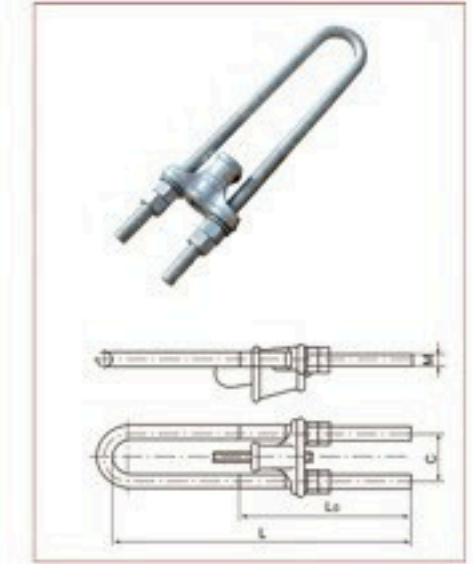

## NU Type Clamp (Non-adjustable)

Clamp body and wedge are cast iron, others are steel, all are hot galvanized.

Type	Steel Wire Dia (mm)	Dimensions (mm)				Rated failure load (kN)
		C	M	L	L1	
NU-1	6.6~7.8	56	16	290	70	45
NU-2	9.1~11.0	62	18	290	70	88
NU-3	13.0~14.0	74	22	290	60	143
NU-4	15.0~16.0	82	24	340	70	164

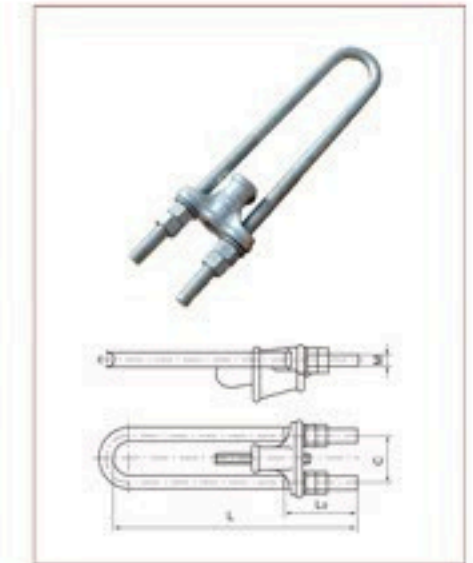

## NX Type Clamp (Adjustable)

Clamp body and wedge are cast iron, others are steel, all are hot galvanized.

Type	Steel Wire Dia (mm)	Dimensions (mm)				Rated failure load (kN)
		C	M	L	L1	
NX-1	6.4~8.6	18	16	150	6	45
NX-2	8.6~12.0	20	18	180	7.3	88
NX-3	12.0~14.5	24	24	200	7.3	143
NX-4	15.0~16.0	28	27	220	8	164

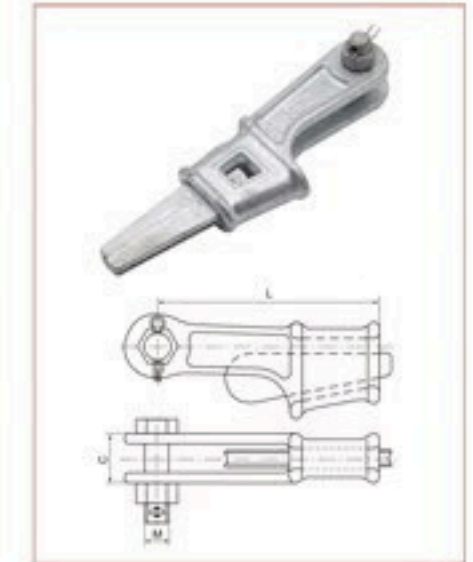

## 1.1 Series Suspension Clamp

The 1.1 series suspension clamp are used to hang LV-ABC cables on poles with the insulated neutral messenger.

- Standard: EN50483-3, NFC 33-040



1.1A



1.1C

Type	Cross-section (mm <sup>2</sup> )	Breaking Load (kN)
1.1A	16-95	9
1.1C	16-95	4

## PS25/120 Suspension Clamp

The PS25/120 suspension clamp are used to hang LV-ABC cables on poles with the insulated neutral messenger.

- Standard: EN50483-3, NFC 33-040



Type	Cross-section (mm <sup>2</sup> )	Breaking Load (kN)
PS25/120	4x25-120	10

## KW94 Suspension Clamp

The KW94 suspension clamp are used to hang LV-ABC cables on poles with the bare messenger.

- Standard: EN50483-3, NFC 33-040



Type	Cross-section (mm <sup>2</sup> )	Breaking Load (kN)
KW94	16-95	15

## KW95 Suspension Clamp

The KW95 suspension clamp are used to hang LV-ABC cables on poles with the insulated neutral messenger.

- Binding bolt equipped with wing nut allows tool free installation.
- Standard: EN50483-3, NFC 33-040



Type	Cross-section (mm <sup>2</sup> )	Breaking Load (kN)
KW95	16-95	22

## PSP25-120 Suspension Clamp

The PSP25-120 suspension clamp are used to hang LV-ABC cables on poles with the insulated neutral messenger.

- Standard: EN50483-3, NFC 33-040



Type	Cross-section (mm <sup>2</sup> )	Breaking Load (kN)
PSP25-120	4x25-120	13

## PS Series Suspension Clamp

The PS suspension clamp is designed for the installation and suspension of four core self-supporting LV-ABC cables to poles or walls.

- The clamp is made of hot-dip galvanized steel and weather resistant material
- Equipped with shear head bolt. The clamp can be easily installed without damaging to the cable jacket
- No loose parts
- Standard: EN 50483-2



Type	Cross-section (mm <sup>2</sup> )	Breaking Load (kN)
PS425	2x25-4x25	15
PS435	4x16-4x35	15
PS470	4x50-4x70	15
PS4120	4x95-4x120	15

## ES1200, ES1500 Suspension Clamp

The ES1500 and 1.1B suspension clamps are used to hang LV-ABC cables on poles with the insulated neutral messenger.

- The anchoring bracket is made of corrosion resistant aluminium alloy
- The clamp and movable link is made of weather resistant and mechanically reliable insulated polymer. Easy cable installation without tools
- The neutral messenger is placed in the groove and locked by an adjustable grip device to fit different cable sizes
- Standard: NFC 33-040, EN 50483-3



Type	Cross-section (mm <sup>2</sup> )	Breaking Load (kN)
ES1200	25-95	12
ES1500	25-95	12
1.1B	25-95	12
1.1D	25-95	12

## PS1500, 1.1F Suspension Clamp

The PS1500 and 1.1F suspension clamps are used to hang LV-ABC cables on poles with the insulated neutral messenger.

- The anchoring bracket is made of corrosion resistant aluminium alloy
- The clamp and movable link is made of weather resistant and mechanically reliable insulated polymer. Easy cable installation without tools
- The neutral messenger is placed in the groove and locked by an adjustable grip device to fit different cable sizes
- Standard: NFC 33-040, EN 50483-3



Type	Cross-section (mm <sup>2</sup> )	Breaking Load (kN)
PS1500	25-95	15
1.1F	25-95	15

## 922, 922B Suspension Clamp

Suspension clamps is designed for suspension support of ABC cable on wooden and concrete poles as well as on the facility walls.

- The clamp and movable link is made of weather resistant and mechanically reliable insulated polymer
- Easy cable installation without tools
- The neutral messenger is placed in the groove and locked by an adjustable grip device to fit different cable sizes
- No loose parts



Type	Cross-section (mm <sup>2</sup> )	Breaking Load (kN)
922	3*95+2*16+50/8	4.5
922B	3*95+2*16+50/8	4.5

## CA1200A, CA1500A, CA2000A Bracket

Pole bracket for pole hardware mount enabling simple or double dead-ending applications on utility poles carrying power lines.

These anchor brackets enable the execution of a simple or double anchoring on low voltage (LV) utility poles.



Type	Breaking Load (kN)
CA1200A	12
CA1500A	15
CA2000A	20

## Bracket



CA25



CA1500



ES1500L



PS1500L



PS1500S



CS16

## APG, Aluminum Parallel Groove Connector

The APG parallel groove clamps are designed to connect two aluminum conductors. Advanced forging technology enhances the mechanical strength of the clamp.



- APG series products are applicable for 30KV and below
- Special designed screw hole and arc shape of the body allow clamp to adjust to different cable size on each side
- Clamp body is made of aluminum with excellent electrical conductivity
- Groove-grooved clamp channels enhance both mechanical pull out strength and electrical conductivity.
- Materials of bolt and nut are depend on customer request. Options include hot-dip galvanized steel and stainless steel. Pressure pad is applied to achieve uniform pressure along the clamp

Type	Conductor cross-section (mm <sup>2</sup> )	Bolts
APG-A1	Al16 ~ 70	1 x M8
APG-A2	Al16 ~ 150	1 x M8
APG-B1	Al16 ~ 35	2 x M8
APG-B2	Al16 ~ 70	2 x M8
APG-B3	Al16 ~ 150	2 x M8
APG-B4	Al25 ~ 185	2 x M10
APG-C1	Al16 ~ 70	3 x M8
APG-C2	Al16 ~ 150	3 x M8
APG-C3	Al25 ~ 240	3 x M10
APG-C4	Al35 ~ 300	3 x M10

## CAPG, Bimetal Parallel Groove Connector

The CAPG parallel groove clamps are designed to connect aluminum conductors and copper conductors. Advanced forging technology enhances the mechanical strength of the clamp.



- CAPG series products are applicable for 30KV and below
- Special designed screw hole and arc shape of the body allow clamp to adjust to different cable size on each side
- Materials of bolt and nut are optional depend on customer request. Options include hot-dip galvanized steel and stainless steel. Pressure pad is applied to achieve uniform pressure along the clamp

Type	Conductor cross-section (mm <sup>2</sup> )	Bolts
CAPG-A1	Cu6 ~ 50 Al16 ~ 70	1 x M8
CAPG-A2	Cu10 ~ 95 Al25 ~ 150	1 x M8
CAPG-B1	Cu6 ~ 50 Al16 ~ 70	2 x M8
CAPG-B2	Cu10 ~ 95 Al25 ~ 150	2 x M8
CAPG-B3	Cu25 ~ 185 Al35 ~ 200	2 x M10
CAPG-C1	Cu6 ~ 50 Al16 ~ 70	3 x M8
CAPG-C2	Cu10 ~ 95 Al25 ~ 150	3 x M8
CAPG-C3	Cu25 ~ 185 Al35 ~ 240	3 x M10
CAPG-C4	Cu35 ~ 240 Al35 ~ 300	3 x M10

## MJPB Pre-Insulated Bimetal Lugs

The MJPB pre-insulated connectors is designed for service and lighting cables.



- Standard: EN 50483-4, NFC 33-021
- Insulation tube is made of weather and UV resistant polymer
- Cross-section of conductor can be easily identified by the color code of rings
- Elastomeric ring and pre-filled grease enable super waterproof performance
- Water tightness test carried out at 6kV for 1 minute under water

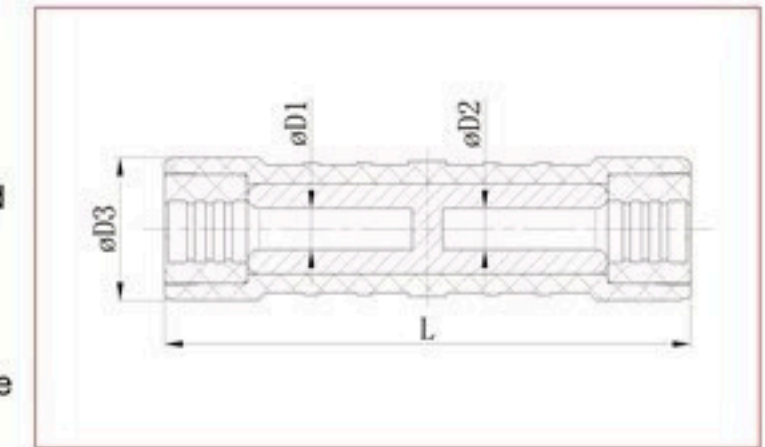

Type	Aluminum full length L1 (mm)	Outer full length L2 (mm)	Dimensions(mm)			Color	Tool
			Dd1	d2	d3		
MJPB 16-6	48	70	5.1	3.1	19	Blue/Green	E140
MJPB 16-10	48	70	5.1	4.1	19	Blue/Brown	E140
MJPB 16-16	48	70	5.1	5.1	19	Blue/Blue	E140
MJPB 25-16	48	70	6.5	5.1	19	Orange/Blue	E140
MJPB 25-25	48	70	6.5	6.5	19	Orange	E140
MJPB 35-35	48	70	7.6	7.6	19	Red	E140

## MJPT Pre-Insulated Sleeve

The MJPT pre-insulated connectors are designed for LV-ABC systems with a neutral messenger. The MJPT is used on the neutral conductor.

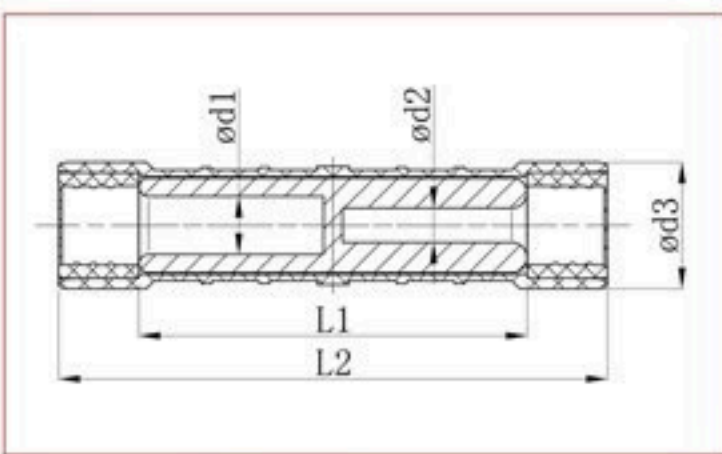

- Stripping of cable insulation is required before insertion
- Clear marks moulded onto the connector body, information including crimping sequence and frequency; Cable size; Stripping length of cable; Crimping die size
- Cross-section of conductor can be easily identified by the color code of rings
- Elastomeric ring and pre-filled grease enable super waterproof performance
- Water tightness test carried out at 6kV for 1 minute under water
- Insulation tube is made of weather and UV resistant polymer
- Standard: EN 50483-4, NFC 33-021

Type	Aluminum full length L1 (mm)	Outer full length L2 (mm)	Dimensions(mm)			Color	Tool
			d1	d2	d3		
MJPT 16-16	73.5	104	5.1	5.1	23	Blue/Blue	E173
MJPT 25-25	73.5	104	6.5	6.5	23	Orange/Orange	E173
MJPT 35-35	73.5	104	7.6	7.6	23	Red/Red	E173
MJPT 50-50	73.5	104	8.9	8.9	23	Yellow/Yellow	E173
MJPT 54-54	73.5	104	9.9	9.9	23	Black/Black	E173
MJPT 70-70	73.5	104	10.5	10.5	23	White/White	E173
MJPT 95-95	73.5	104	12.4	12.4	23	Gray/Gray	E173
MJPT 120-120	73.5	107.6	13.6	13.6	26.5	Pink/Pink	E215
MJPT 150-150	73.5	107.6	15.2	15.2	26.5	Purple/Purple	E216

## MJPTN Pre-Insulated Sleeve

The MJPTN pre-insulated connectors are designed for LV-ABC systems with a neutral messenger. The MJPTN is used on the neutral conductor.

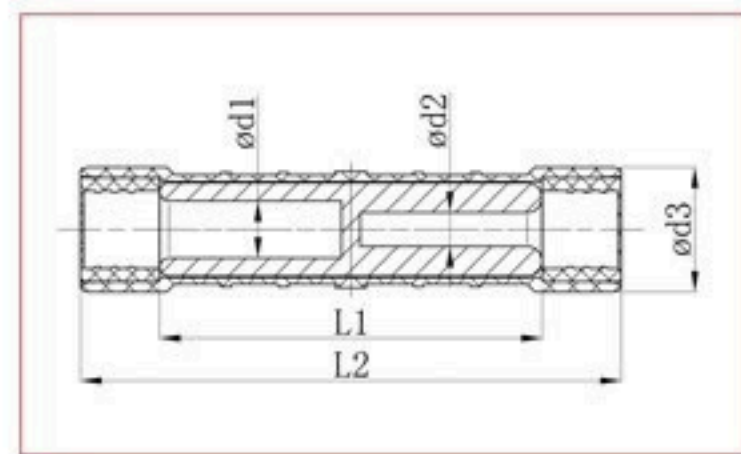

- Stripping of cable insulation is required before insertion
- Clear marks moulded onto the connector body, information including crimping sequence and frequency; Cable size; Stripping length of cable; Crimping Die size
- Cross-section of conductor can be easily identified by the color code of rings
- Elastomeric ring and pre-filled grease enable super waterproof performance.
- Pre-filled with jointing compound
- Water tightness test carried out at 6kV for 1 minute under water
- Insulation tube is made of weather and UV resistant polymer
- Standard: EN 50483-4, NFC 33-021

Type	Aluminum full length L2 (mm)	Outer full length L (mm)	Dimensions(mm)			Color	Tool
			d1	d2	d3		
MJPT 50N	172	140	8.9	8.9	23	Yellow	E173
MJPT 54N	172	140	9.8	9.8	23	Black	E173
MJPT 70N	172	140	10.5	10.5	23	White	E173
MJPT 95N	172	140	12.4	12.4	23	Gray	E173

## CPTAU Pre-Insulated Bimetal Lugs

The CPTAU pre-insulated bimetal lug is used to establish connection between LV-ABC cable and electrical equipments. Palm is made of 99.9% pure copper and sleeve is made of 99.5% pure aluminum.



- Prefilled with jointing compound
- Standard: EN 50483-4, NFC 33-021
- Water tightness test carried out at 6kV for 1 minute under water
- Insulation tube is made of weather and UV resistant polymer

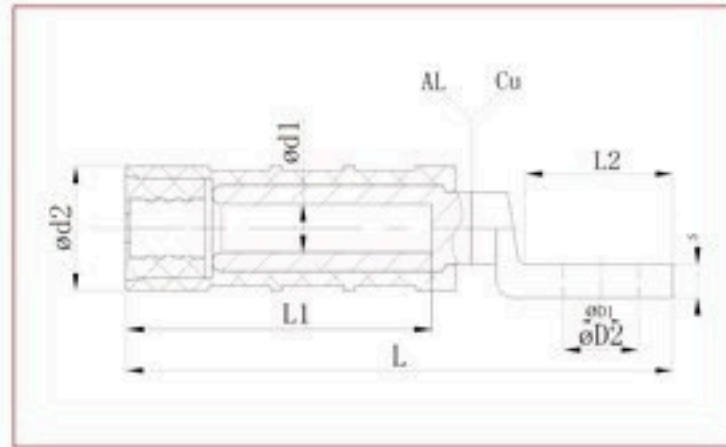

Type	Aluminum full length L1 (mm)	Outer full Length L (mm)	Copper head outer diameter D2 (mm)	Dimensions(mm)					Color	Tool
				d1	D1	d2	L2	S		
CPTAU16	42	76	Φ20	5.1	10.5	17.3	20	4.6	Blue	E140
CPTAU25	42	76	Φ20	6.5	10.5	17.3	20	4.6	Orange	E140
CPTAU35	53.5	96	Φ25	7.6	13	22	26	6	Red	E173
CPTAU50	53.5	96	Φ25	8.9	13	22	26	6	Yellow	E173
CPTAU54	53.5	96	Φ25	9.8	13	22	26	6	Black	E173
CPTAU70	53.5	96	Φ25	10.5	13	22	26	6	White	E173
CPTAU95	53.5	96	Φ25	12.4	13	22	26	6	Gray	E173
CPTAU120	64.5	121	Φ30.5	13.6	13	26.5	32	7.8	Pink	E215
CPTAU150	64.5	121	Φ30.5	15.2	13	26.5	32	7.8	Purple	E215

## H Type Clamp

JH clamp is a kind of connecting clamp used for all kinds of high and low tension & non-tension wire, suitable for steel core aluminum wire (LGJ), aluminum stranded wire(LJ), aluminum wire overhead insulated cable (JKLYJ) Core aluminum wire overhead insulated cable (JKIGYG), copper wire and other materials free to connect.

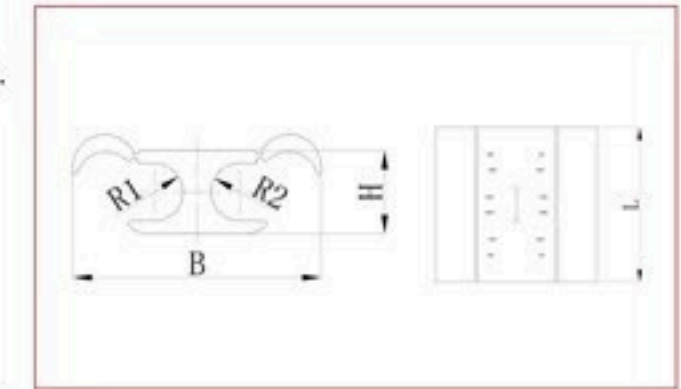

### Structure Feature

- The resistance is small, low temperature, saving energy, safe and reliable
- Clamp is made of high strength aluminum alloy, safe and stable

Type	Main Line (mm)	Branch Line (mm)	Product Size(mm)			
			L	R1	R2	H
JH-1	4.8-8.2	4.8-8.2	38	4.5	4.5	15.5
JH-2	8.4-14	4.8-9.6	48	7.5	5.8	22.5
JH-3	8.4-14	8.4-14	60	7.5	7.5	22.5
JH-4	11.6-22.4	4.8-11.6	51	12	6.5	32
JH-5	11.6-22.4	10-16	51	12	8.5	32
JH-6	14.6-22.4	14.6-22.4	89	12	12	32

## JXD Wedge Clamp

JXD series wedge clamp is suitable for no-bearing connecting of conductor for overhead distribution circuit, also for mating aluminum connection, overhead insulated aluminum wire, insulation sheath or clamp, it takes effect on protection.

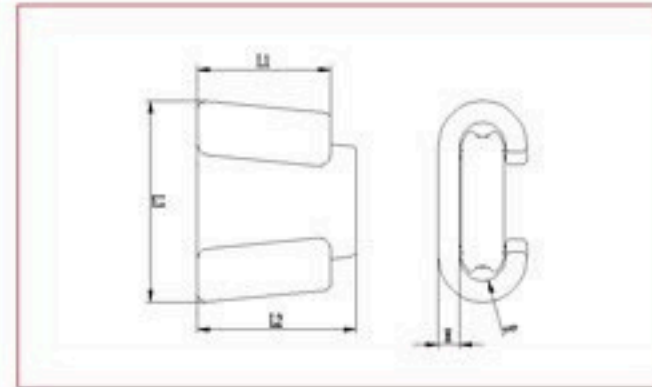

### Structure Feature

- It can save energy
- Good contacting performance, big contacting surface for wedge elastic damping and conductor stable clamping force the rate of DC resistance is 0.85-0.9
- Strong overload capacity, wedge elastic damp and over load capacity is 2 times of rated current
- Good thermal circle performance, operating under the rate of DC resistance for less than 1 all the time.
- Gain the aim of free maintenance, no- failure and longlife
- Suitable for kinds of conductor composite, strong applicability, mating insulation sheath, it realizes circuit insulation.

Type	Main Line (mm <sup>2</sup> )	Branch Line (mm <sup>2</sup> )	Product Size(mm)				
			L1	L2	L3	H	R
JXD-1	16-120	16-120	42	50	64	6.8	7.2
JXD-2	120-150	16-150	50	56	68.5	7	8
JXD-3	185	25-185	76	86	91	8	10
JXD-4	240	25-240	76	86	95.5	8	12

## Bolt Type C Clamp

### Structure Feature

- Made of non-magnetic material, no electric loss
- Wedge type resistant contact
- Easy installation and dismantle
- Able to cooperate with many kinds of conductor
- High flexibility, re-usable, long service life

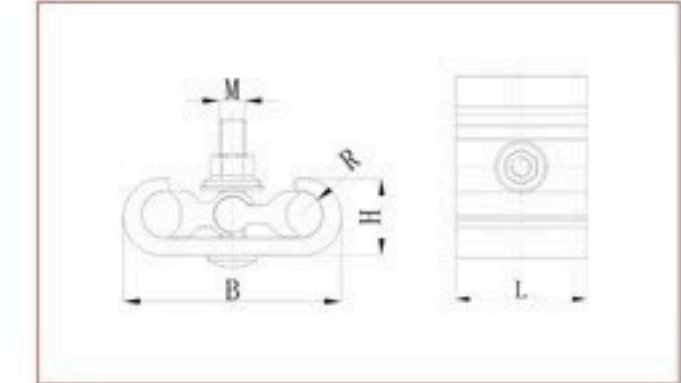

Type	Main Line (mm <sup>2</sup> )	Branch Line (mm <sup>2</sup> )	Product Size(mm)			
			B	R	L	M
KY-C1	240	35-240	104	11.5	75	12
KY-C2	185	35-185	87	9.7	70	12
KY-C3	150	35-150	75	8.7	52	10
KY-C4	120	16-120	71	8	52	10
KY-C5	70-95	16-95	64	6.4	50	10
KY-C6	16-50	16-50	64	6.4	40	10

## Stainless Steel Strap & Cable Ties

### Main Features:

1. Stainless steel has good anti-corrosion and anti-oxidation functions, and different grades of stainless steel can adapt to various environments;
2. The surface of the steel strip is marked with a metric mark every 10cm. The user can use the mark to accurately measure the required length, improve construction efficiency and reduce waste.
3. It needs to be used with stainless steel buckles. It can be used in various sizes for different environments and tension requirements. In theory, it can provide up to 1.5 tons of bundle tension.
4. Usually use economical carton packaging, users can also choose portable plastic box packaging, easy to carry out emergency maintenance and high-altitude operation of the facility.



Width		Thickness		Breaking load	Package
Inch	(mm)	Inch	(mm)		
1/4	6.4	0.02	0.5	500	30m/roll
3/8	9.5	0.025	0.64	900	
1/2	12.7	0.03	0.76	1500	
5/8	16	0.03	0.76	1875	
3/4	19	0.03	0.76	2250	

## Band Strap Installation

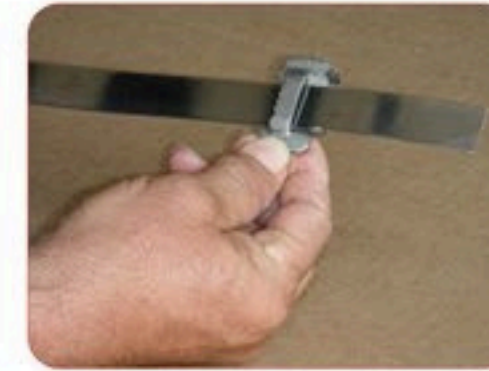

1. Cut a length of stainless steel cable tie according to the actual use, put the buckle to one end of the cable tie and reserve a length of about 5cm.



2. Bend the reserved cable tie to fix the stainless steel buckle.



3. Put the another end of the stainless steel cable tie as picture shows, and set aside 10cm for the tool to use when tightening the cable tie.



4. Tie the straps with the strap presser and start to shake the straps slowly to tighten the straps to ensure that the straps are tight.



5. When the cable tie is tightened, fold the whole of the tight belt back, and then pull the handle of the tight belt blade to cut off the cable tie.



6. Hammer the two corners of the buckle with a hammer to catch the last reserved tie head.

### Teeth Buckle



Type	Width		Thickness
	Inch	(mm)	(mm)
KW-NB6.4	1/4	6.4	0.8
KW-NB10	3/8	9.5	1.0
KW-NB12.7	1/2	12.7	1.2
KW-NB16	5/8	16	1.2
KW-NB20	3/4	20	1.4
KW-NB25	1"	25	1.8
KW-NB32	1-1/4	32	2.2

### L Type Buckle



Type	Width		Thickness
	Inch	(mm)	(mm)
KW-NC6.4	1/4	6.4	0.7
KW-NC10	3/8	9.5	0.7
KW-NC12.7	1/2	12.7	0.8
KW-NC16	5/8	16	0.8
KW-NC20	3/4	20	1
KW-NC25	1"	25	1.2
KW-NC32	1-1/4	32	1.2

### Other Fittings



Cable Saddle



End Cap



C200



PMCC Male



PMCC Female



Fuse Holder



Butterfly Branch-1



Nail



KWH1



MKC

## OPTICAL FIBER CABLE ACCESSORIES

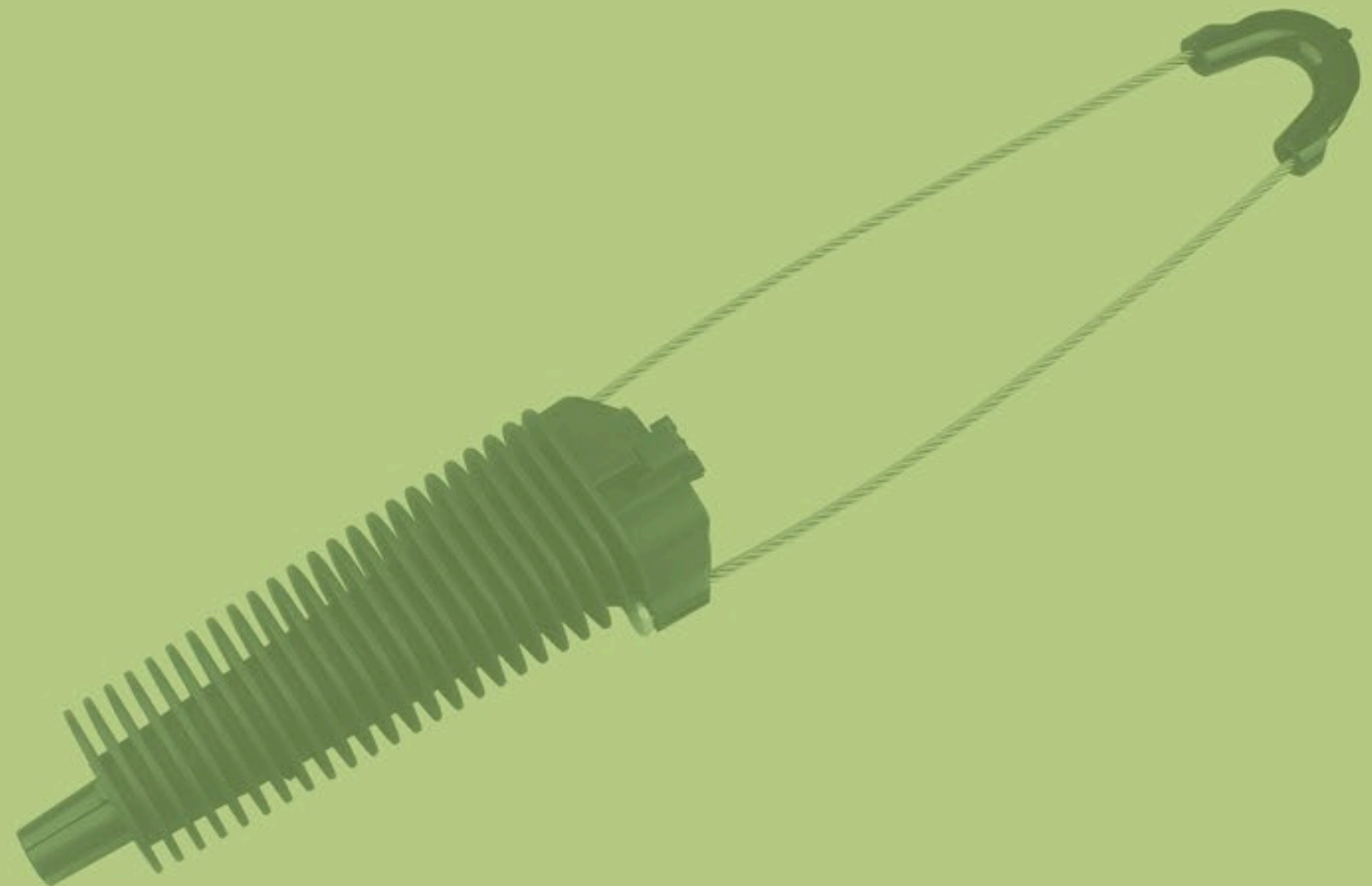

## Anchor Clamp for Round Cables

The anchoring clamps are designed for a fast, easy and reliable dead-ending of fiber optic cables on access networks with spans up to 100 m.

A pair of wedges grips the cable automatically within the conical body. The installation does not require any specific tools and the operating time is drastically reduced.



PA300



PA500



PA600

Model	Cable Diameter (mm)	Break Load (kN)
PA300	4-8	2.5
PA500	4.5-9	2.5/4
PA600	8-15	4/5/10
PA600B	14-18	4/5/10

## Instructions for Installation

Anchoring clamps for ADSS cables installed on short spans (100 m max.)



## PAL1500D Tension Clamp for Round Cables



Model	Cable Diameter (mm)	Break Load (kN)
PAL1500D	12-15	15

## PA39 Tension Clamp for Figure 8 Cable



Model	Cable Diameter (mm)	Break Load (kN)
PA39	3-9	4

## PA56 Tension Clamp for Figure 8 Cable



Model	Cable Diameter (mm)	Break Load (kN)
PA56	5-6	1.2

### PA03/PA05 Tension Clamp for Figure 8 Cable



Model	Cable Diameter (mm)	Break Load (kN)
PA03	3-7	1.2
PA05	1.5-6	2

### PA06/PA07 Tension Clamp for Figure 8 Cable



Model	Cable Diameter (mm)	Break Load (kN)
PA06	2-6	4
PA07	3-7.5	4

### PA08/PA09 Tension Clamp for Figure 8 Cable



Model	Cable Diameter (mm)	Break Load (kN)
PA08	3.5-6.5	5.5
PA09	5-10	8

### ODWAC Tension Clamp for Round Cable



Model	Cable Diameter (mm)	Break Load (kN)
ODWAC-20	2*6	1
ODWAC-21T	2*6	1

### ODWAC Tension Clamp for FTTH Cable



Model	Cable Diameter (mm)	Break Load (kN)
ODWAC-22/26	2*6	1
ODWAC-22G	2*6	1

### ODWAC Tension Clamp for FTTH Cable



Model	Cable Diameter (mm)	Break Load (kN)
ODWAC-22S	(2-3)*(4-8)	0.5
ODWAC-22H	(2-3)*(4-8)	1

## ODWAC Tension Clamp for FTTH Cable



Model	Cable Diameter (mm)	Break Load (kN)
ODWAC-24	2*5	1
ODWAC-24S	2*5	0.5
ODWAC-24SL	2*5	0.5

## S-Type Tension Clamp for FTTH Cable

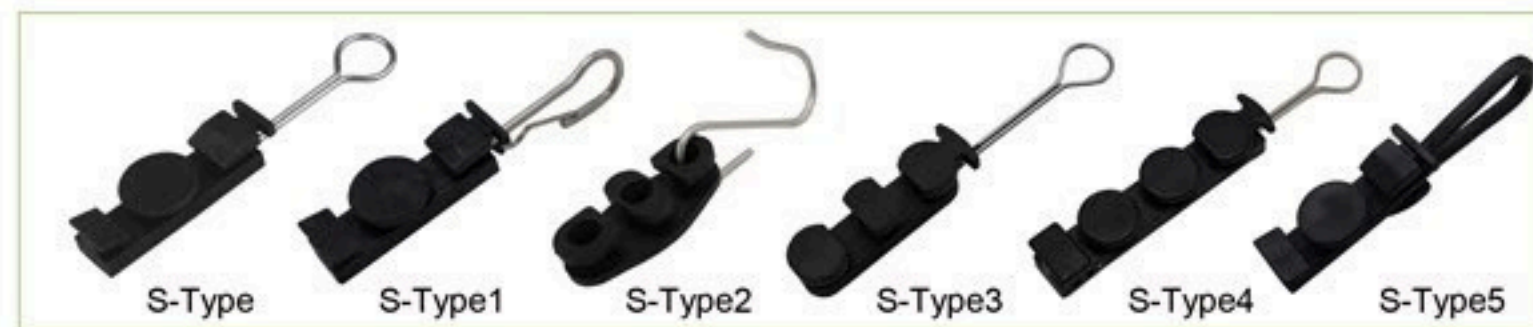

Model	Cable Diameter (mm)	Break Load (kN)
S-Type	2*5	0.8

## C350 Tension Clamp for FTTH Cable



Model	Cable Diameter (mm)	Break Load (kN)
C350	3.0,2*3.1,3.3*2,5*2	0.8
C350-1	2*5	0.8
C350-2	2*3	0.5

## C360 Tension Clamp for FTTH Cable



Model	Cable Diameter (mm)	Break Load (kN)
C360	3-7	0.8

## C370 Tension Clamp for FTTH Cable



Model	Cable Diameter (mm)	Break Load (kN)
C370	2*5	0.8

## HC Optical Fiber Suspension Clamp

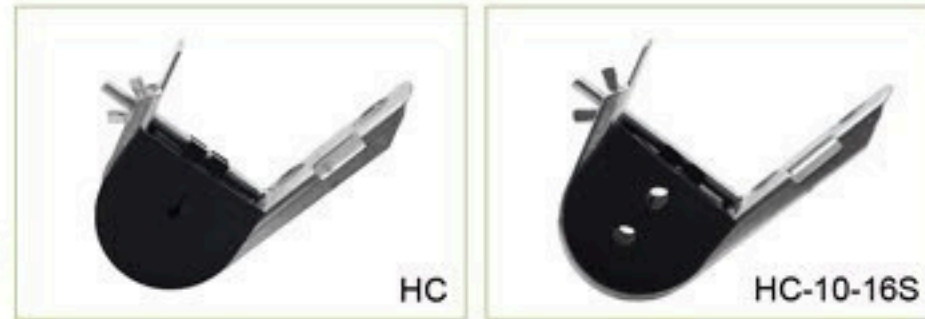

Hook clamps are designed to provide a suspension for 10 to 20 mmaerial ADSS cables at intermediate poles on cable routes with angle <math><20^\circ</math> on access networks (spans up to 100 m).

The suspension clamp for ADSS cable consists of a galvanized steel J hook, a neoprene sleeve and tightening screw.

The clamp may be installed on poles using either a pig tail bolt or 2 pole bands.

Model	Cable Diameter (mm)	Break Load (kN)
HC-5-8	5-8	4
HC-8-12	8-12	4
HC-10-15	10-15	4
HC-15-20	15-20	4
HC-10-16S	2x10-16	4

## JHC/KHC Optical Fiber Suspension Clamp



Model	Cable Diameter (mm)	Break Load (kN)
JHC-5-8	5-8	8
JHC-8-12	8-12	8
JHC-10-15	10-15	8
JHC-12-16	12-16	8
KHC-8-12	8-12	8
KHC-12-18	12-18	8

## CS/SSA/SSA-1 Optical Fiber Suspension Clamp



These suspension clamps are designed for distribution networks with spans up to 70 m.

Model	Cable Diameter (mm)	Break Load (kN)
CS	4-5 / 5-9	8
SSA	4-5 / 5-9	8
SSA-1	3-9	8

## ACC Clamp for Round Drop Wires



The drop wire clamp is composed of a mandrel shaped body and an opened bail that can be locked into the clamp body. It is made out of UV resistant nylon.

Model	Cable Diameter (mm)	Break Load (kN)
ACC	2-6	0.8

## D6/D8 Optical Fiber Suspension Clamp



Model	Cable Diameter (mm)	Break Load (kN)
D6	4-8	0.3
D8-02	2-4	/
D8-06	6-8	/
D8-08	8-10	/
D8-10	10-15	/

## ZP-8-2 Optical Fiber Suspension Clamp



Model	Cable Diameter (mm)	Break Load (kN)
ZP-8-2	4-8	2

## CT-8 Perforated Metal Angle Bracket



Model	Break Load (kN)
CT-8	15

## YTA/YTO Down Lead Clamp for Tower



Model	Cable Diameter (mm)
YTA	8-17
YTO	7-18

## YGA/YGO Down Lead Clamp for Pole



Model	Cable Diameter (mm)
YGA	8-17
YGO	7-18

## LT/LTW Cable Storage Assembly for Tower



Model	L1(mm)	L2(mm)
LT	400	1200
LTW	400	900

## LG/LGW Cable Storage Assembly for Pole

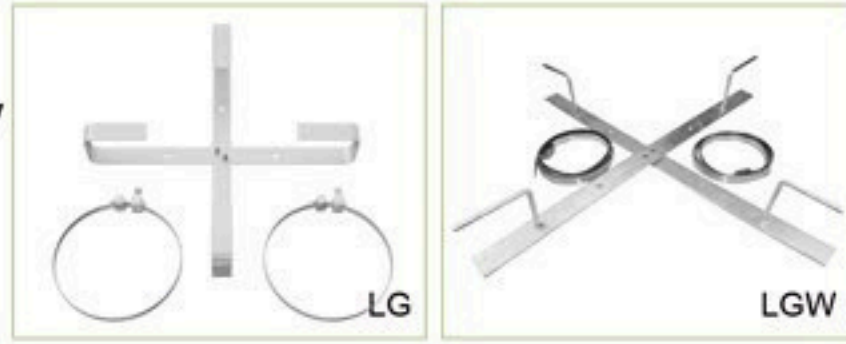

Model	L1(mm)	L2(mm)
LG	400	1200
LGW	400	900

## Fiber Storage Units

Fiber Storage Units are used to storage mounting of cable.  
It can be used overhead on wire or mounting on pole or wall.



Model	Channel (mm)	Out Side (mm)	Inside Round(mm)	Minimum Bend Diameter(mm)	Storage Cable Length(m)
FSU-D600	45x45	440x640x45	400	20	12
FSU-D400	45x45	390x418x50	300	20	12
FSU-D400S	100x117	390x100x117	300	20	30

## Preformed Line Suspension Clamp for ADSS

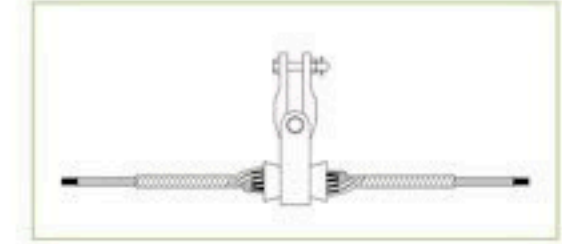

Model	Overall Diameter (mm)	U T S (kN)					
		020	030	040	050	060	070
		Span(m)					
KW-ATX-1000	9.5-10.0	200	—	—	—	—	—
KW-ATX-1110	10.1-11.1	200	300	400	—	—	—
KW-ATX-1220	11.2-12.2	200	300	400	500	—	—
KW-ATX-1330	12.3-13.3	200	300	400	500	600	700
KW-ATX-1440	13.4-14.4	200	300	400	500	600	700
KW-ATX-1550	14.5-15.5	200	300	400	500	600	700
KW-ATX-1660	15.6-16.6	200	300	400	500	600	700
KW-ATX-1770	16.7-17.7	200	300	400	500	600	700
KW-ATX-1880	17.8-18.8	200	300	400	500	600	700
KW-ATX-1990	18.9-19.9	200	300	400	500	600	700
KW-ATX-2110	20.0-21.0	200	300	400	500	600	700
KW-ATX-2200	21.1-22.0	200	300	400	500	600	700

## Preformed Line Suspension Clamp for OPGW

Model	Overall Diameter (mm)	U T S (kN)		
KW-OTX-1000	9.5-10.0	040	070	—
KW-OTX-1110	10.1-11.1	040	070	100
KW-OTX-1220	11.2-12.2	040	070	100
KW-OTX-1330	12.3-13.3	040	070	100
KW-OTX-1440	13.4-14.4	040	070	100
KW-OTX-1550	14.5-15.5	040	070	100
KW-OTX-1660	15.6-16.6	040	070	100
KW-OTX-1770	16.7-17.7	040	070	100
KW-OTX-1880	17.8-18.8	040	070	100
KW-OTX-1990	18.9-19.9	040	070	100
KW-OTX-2110	20.0-21.0	040	070	100
KW-OTX-2200	21.1-22.0	040	070	100

## Preformed Line Double Suspension Clamp for ADSS/OPGW

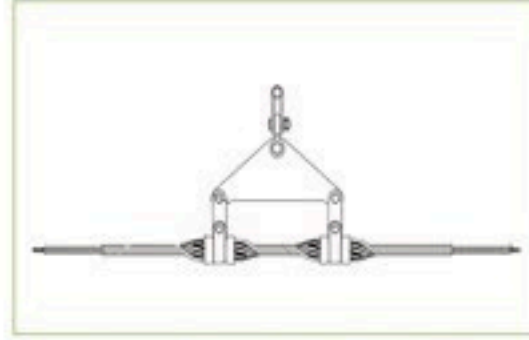

Model	Overall Diameter (mm)	Model	Overall Diameter (mm)
K-ATX2-1000 070	9.5-10.0	K-ATX2-1000 070	9.5-10.0
K-ATX2-1110 070	10.1-11.1	K-ATX2-1110 070	10.1-11.1
K-ATX2-1220 070	11.2-12.2	K-ATX2-1220 070	11.2-12.2
K-ATX2-1330 070	12.3-13.3	K-ATX2-1330 070	12.3-13.3
K-ATX2-1440 070	13.4-14.4	K-ATX2-1440 070	13.4-14.4
K-ATX2-1550 070	14.5-15.5	K-ATX2-1550 070	14.5-15.5
K-ATX2-1660 070	15.6-16.6	K-ATX2-1660 070	15.6-16.6
K-ATX2-1770 070	16.7-17.7	K-ATX2-1770 070	16.7-17.7
K-ATX2-1880 070	17.8-18.8	K-ATX2-1880 070	17.8-18.8
K-ATX2-1990 070	18.9-19.9	K-ATX2-1990 070	18.9-19.9
K-ATX2-2110 070	20.0-21.0	K-ATX2-2110 070	20.0-21.0
K-ATX2-2220 070	21.1-22.0	K-ATX2-2220 070	21.1-22.0

## Preformed Line Tension Clamp for ADSS

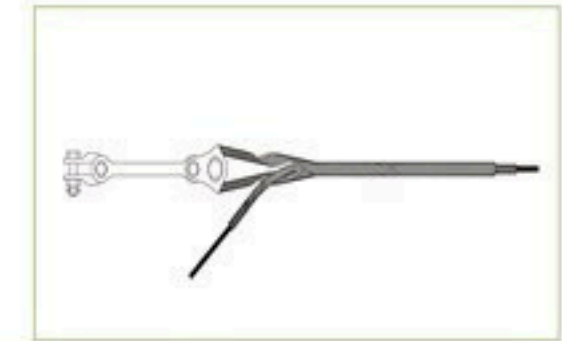

Model	Overall Diameter (mm)	UTS (kN)							
		010	020	030	040	050	060	070	080
		Span(m)							
KWAN 1000	9.0-10.0	100	200	—	—	—	—	—	—
KWAN 1110	10.1-11.1	100	200	300	400	—	—	—	—
KWAN 1220	11.2-12.2	100	200	300	400	500	—	—	—
KWAN 1330	12.3-13.3	100	200	300	400	500	600	—	—
KWAN 1440	13.4-14.4	100	200	300	400	500	600	700	800
KWAN 1550	14.5-15.5	100	200	300	400	500	600	700	800
KWAN 1660	15.6-16.6	100	200	300	400	500	600	700	800
KWAN 1770	16.7-17.7	100	200	300	400	500	600	700	800
KWAN 1880	17.8-18.8	100	200	300	400	500	600	700	800

Optical Cable Fittings

Optical Cable Fittings

## Tangent Suspension Clamp for ADSS

<100m Span's Tangent Suspension Clamp

Model	Overall Diameter (mm)
KW-QX-1180	9.6-11.8
KW-QX-1380	11.9-13.8
KW-QX-1580	13.9-15.8

100~200m Span's Tangent Suspension Clamp

Model	Overall Diameter (mm)
KW-QX-1000 030	9.5-10.0
KW-QX-1110 030	10.1-11.1
KW-QX-1220 030	11.2-12.2
KW-QX-1330 030	12.3-13.3
KW-QX-1440 030	13.4-14.4
KW-QX-1550 030	14.5-15.5
KW-QX-1660 030	15.6-16.6
KW-QX-1770 030	16.7-17.7
KW-QX-1880 030	17.8-18.8
KW-QX-1990 030	18.9-19.9
KW-QX-2100 030	20.0-21.0
KW-QX-2220 030	21.1-22.0

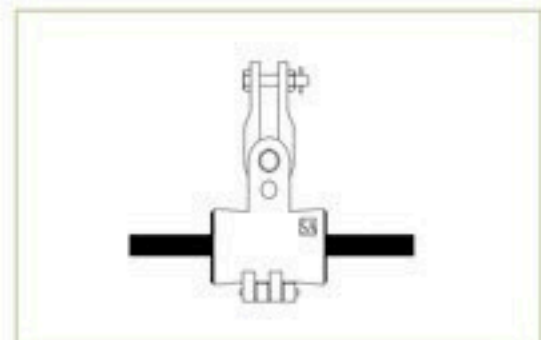

## Short-Span Preformed Line Tension Clamp for ADSS

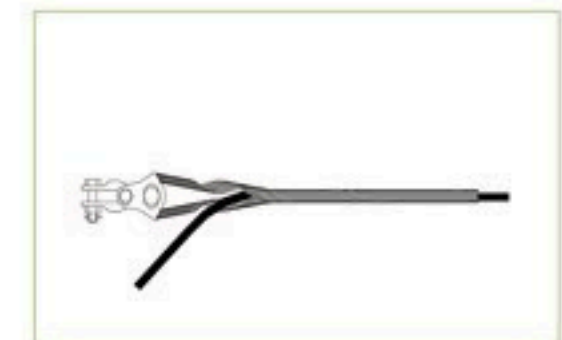

Model	Cable Diameter (mm)	UTS (kN)
KWAN 1000 020-D	9.0-10.0	20
KWAN 1110 020-D	9.0-10.0	20
KWAN 1220 020-D	9.0-10.0	20
KWAN 1330 020-D	9.0-10.0	20
KWAN 1440 020-D	9.0-10.0	20
KWAN 1550 020-D	9.0-10.0	20
KWAN 1660 020-D	9.0-10.0	20
KWAN 1770 020-D	9.0-10.0	20
KWAN 1880 020-D	9.0-10.0	20

## Preformed Line Single Tension Clamp for OPGW

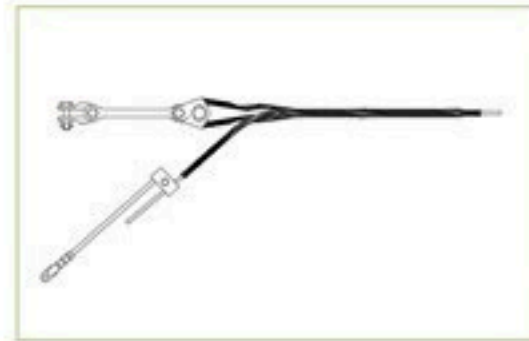

Model	Overall Diameter (mm)		UTS (kN)		
KWON 1110	10.1-11.1	070	—	—	—
KWON 1220	11.2-12.2	070	100	—	—
KWON 1330	12.3-13.3	070	100	120	—
KWON 1440	13.4-14.4	070	100	120	160
KWON 1550	14.5-15.5	070	100	120	160
KWON 1660	15.6-16.6	070	100	120	160
KWON 1770	16.7-17.7	070	100	120	160
KWON 1880	17.8-18.8	070	100	120	160
KWON 1990	18.9-19.9	070	100	120	160
KWON 2100	20.0-21.0	070	100	120	160
KWON 2200	21.1-22.0	070	100	120	160

## Preformed Line Double Tension Clamp for OPGW



Model	Cable Diameter (mm)	UTS (kN)
KWON 1330	12.3-13.3	160
KWON 1440	13.4-14.4	160
KWON 1550	14.5-15.5	160
KWON 1660	15.6-16.6	160
KWON 1770	16.7-17.7	160
KWON 1880	17.8-18.8	160
KWON 1990	18.9-19.9	160
KWON 2110	20.0-21.0	160
KWON 2220	21.1-22.0	160

## ADSS Connecting Clamp & Bracket

KW1604	KW1605	KW1607	KW1607-2
KWMH	YK01	YKP-03	KW1700
KW1610	KW1612	KW1613	KW1666-7
KW1608	KW1609	UPB	UPB-B
YK02	YK04	YK08	YKP-01
YKP-04	YKP-05	KW1606	BG-3

# CABLE LUGS

Cable Lugs



## BLMT Aluminum Mechanical Cable Lugs



Model	Cable Size (mm <sup>2</sup> )	Diameter of mounting hole		Dimensions(mm)			Bolt QTY.	AF
		LB	L1	L2	D1	D2		
BLMT-25/95-13	25-95	13	60	30	24	12.8	1	13
BLMT-35/150-13	35-150	13	85	35	28	15.8	1	17
BLMT-95/240-13	95-240	13	112	60	33	20	2	19
BLMT-120/300-17	120-300	17	115	65	37	24	2	22
BLMT-185/400-17	185-400	17	137	80	42	25.5	3	22
BLMT-500/630-17	500-630	17	175	95	50	33.3	3	27

Cable Lugs

## AMB Aluminum Mechanical Cable Lugs



Model	Cable Size (mm <sup>2</sup> )	Dimensions(mm)		Bolt QTY.	AF2
		L1	D1		
AMB-10/35	10-35	45	19	2	10
AMB-25/95	25-95	65	24	2	13
AMB-35/150	35-150	80	28	2	17
AMB-95/240	95-240	125	33	4	19
AMB-120/300	120-300	140	37	4	22
AMB-185/400	185-400	170	42	6	22
AMB-500/630	500-630	200	50	6	27



## RML Aluminum Mechanical Cable Lugs

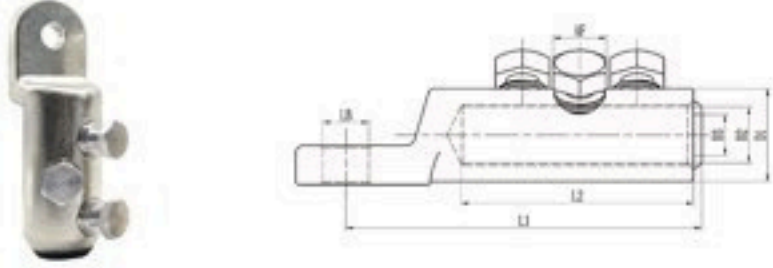

Model	Cable Size (mm <sup>2</sup> )	Diameter of mounting hole		Dimensions(mm)				Bolt QTY.	AF
		LB	L1	L2	D1	D2	D3		
RML-16/95	16-95	13	64	40	24	14	9.6	2	13
RML-25/150	25-150	13	82	52	30	16	10.8	2	14
RML-70/240	70-240	17	104	68	33	20	16	2	19
RML-120/300	120-300	17	115	74	38	25	15	2	22
RML-185/400	185-400	17	137	95	42	26	20	3	22
RML-400/630	400-630	17	150	100	52	33	25	3	24

## CLL Aluminum Mechanical Connector



Model	Conductor Size(mm)	Outer Diameter	Number of Bolts	Shear-off Torque (Nm)	Wrench Size
CLL10-35/2	10-35	16	2	8	9
CLL25-50/2	25-50	18	2	12	10
CLL50-95/2	50-95	22	2	22	13
CLL120-185/2	120-185	30	2	44	17
CLL240-300/4	240-300	36	4	55	22

## RMB Aluminum Mechanical Cable Lugs

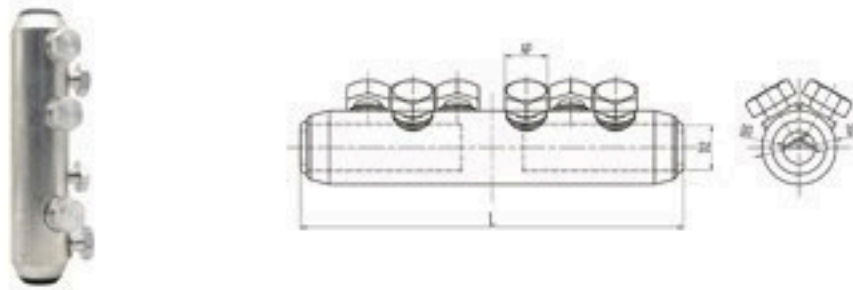

Model	Cable Size (mm <sup>2</sup> )	Dimensions(mm)				Bolt QTY.	AF
		L1	D1	D2	D3		
RMB-16/95	16-95	84	24	14	9.6	4	13
RMB-25/150	25-150	105	30	16	10.8	4	14
RMB-70/240	70-240	134	33	20	16	4	19
RMB-120/300	120-300	151	38	25	15	4	22
RMB-185/400	185-400	194	42	26	20	6	22

## JTLL Mechanical Bimetal Lug



Model	Conductor Size(mm)	Outer Diameter	Number of Bolts	Shear-off Torque (Nm)	Wrench Size
JTLL10-35-8/1	10-35	16	1	8	9
JTLL10-35-10/1	10-35	16	1	9	9
JTLL50-95-8/1	50-95	22	1	22	13
JTLL50-95-10/1	50-95	22	1	22	13
JTLL120-185-10/1	120-185	30	1	40	17
JTLL120-185-12/1	120-185	30	1	40	17
JTLL240-300-10/2	240-300	36	2	55	22
JTLL240-300-12/2	240-300	36	2	55	22

Cable Lugs

Cable Lugs

## AUL Mechanical Aluminum Lug



Model	Conductor Size(mm)	Outer Diameter	Number of Bolts	Shear-off Torque (Nm)	Wrench Size
AUL25-95-12/1	25-95	24	1	17	13
AUL25-95-16/1	25-95	24	1	17	13
AUL35-150-12/1	35-150	28	1	31	17
AUL35-150-16/1	35-150	28	1	31	17
AUL35-150-12/2	35-150	28	2	31	17
AUL35-150-16/2	35-150	28	2	31	17
AUL70-240-12/2	70-240	33	2	36	19
AUL70-240-16/2	70-240	33	2	36	19
AUL120-300-12/2	120-300	38	2	40	22
AUL120-300-16/2	120-300	38	2	40	22
AUL185-400-12/2	185-400	42	2	56	22
AUL185-400-16/2	185-400	42	2	56	22
AUL185-400-12/3	185-400	42	3	43	22
AUL185-400-16/3	185-400	42	3	43	22
AUL500-630-12/3	500-630	52	3	56	24
AUL500-630-16/3	500-630	52	3	56	24
AUL500-630-20/3	500-630	52	3	56	24

## AULZ Mechanical Aluminum Lug



Model	Conductor Size(mm)	Outer Diameter	Number of Bolts	Shear-off Torque (Nm)	Wrench Size
AULZ25-95-16/1	25-95	24	1	17	13
AULZ70-240-16/2	70-240	33	2	36	19
AULZ185-400-16/3	185-400	42	3	43	22

## GLL Mechanical Aluminum Connector



Model	Conductor Size(mm)	Outer Diameter	Number of Bolts	Shear-off Torque (Nm)	Wrench Size
GLL10-35/2	10-35	19	2	8	9
GLL25-95/2	25-95	24	2	17	13
GLL35-150/2	35-150	28	2	31	17
GLL35-150/4	35-150	28	4	31	17
GLL70-240/4	70-240	33	4	36	19
GLL120-300/4	120-300	38	4	40	22
GLL185-400/4	185-400	42	4	56	22
GLL185-400/6	185-400	42	6	43	22
GLL500-630/6	500-630	52	6	56	24

## DTLL Mechanical Bimetal Lug



Model	Conductor Size(mm)	Outer Diameter	Number of Bolts	Shear-off Torque (Nm)	Wrench Size
DTLL25-95-12/1	25-95	24	1	17	13
DTLL35-150-12/1	35-150	28	1	31	17
DTLL35-150-16/1	35-150	28	1	31	17
DTLL35-150-12/2	35-150	28	2	31	17
DTLL35-150-16/2	35-150	28	2	31	17
DTLL70-240-12/2	70-240	33	2	36	19
DTLL70-240-16/2	70-240	33	2	36	19
DTLL70-300-16/2	120-300	38	2	40	22
DTLL120-300-16/2	120-300	38	2	40	22
DTLL185-400-12/2	185-400	42	2	56	22
DTLL185-400-16/2	185-400	42	2	56	22
DTLL185-400-12/3	185-400	42	3	43	22
DTLL185-400-16/3	185-400	42	3	43	22
DTLL500-630-12/3	500-630	52	3	56	24
DTLL500-630-16/3	500-630	52	3	56	24
DTLL500-630-20/3	500-630	52	3	56	24

Cable Lugs

Cable Lugs

## DTL-1 Bimetal Cable Lugs

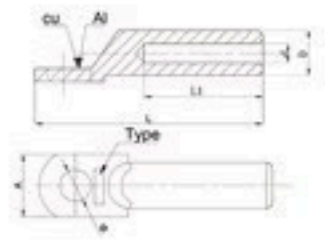

Model	Dimensions(mm)					
	Φ	d	D	L	L1	A
DTL-1-16	8.5	6	11	70	32	16
DTL-1-25	8.5	7	12	76	37	18
DTL-1-35	10.5	8.5	14	85	39	20
DTL-1-50	10.5	9.5	16	91	42	23
DTL-1-70	12.5	11.5	18	102	47	26
DTL-1-95	12.5	13.5	20	110	50	28
DTL-1-120	14.5	15	23	120	55	31.5
DTL-1-150	14.5	16.8	25	125	56	34
DTL-1-185	16.5	18.5	27	132	58	37
DTL-1-240	16.5	21	30	140	60	40
DTL-1-300	18.5	23	34	152	66	45
DTL-1-400	21	26	38	170	70	50

## DTL-2 Bimetal Cable Lugs

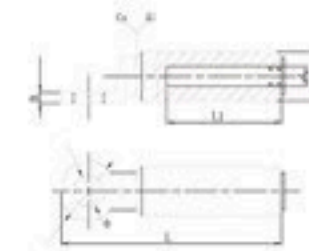

Model	Dimensions(mm)					
	Φ	d	L	L1	B	D
DTL-2-16	11	5.5	80	38	3.5	16
DTL-2-25	11	6.5	80	38	3.5	16
DTL-2-35	11	8.2	80	38	3.5	16
DTL-2-50	13	9.7	90	43	4.5	20
DTL-2-70	13	11	90	43	4.5	20
DTL-2-95	13	12.5	90	43	4.5	20
DTL-2-120	13	14.5	114	58	5.5	25
DTL-2-150	13	16.5	114	58	5.5	25
DTL-2-185	13	17.5	124	60	6	32
DTL-2-240	13	19.5	124	60	6	32
DTL-2-300	13	23	130	60	6.5	34
DTL-2-400	13	26	155	90	7	40
DTL-2-500	13	29	155	90	7	40

## DLT Bimetal Cable Lugs

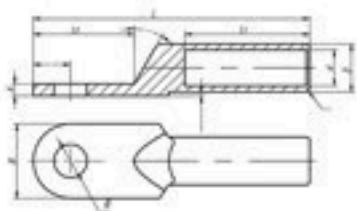

Model	Dimensions(mm)						
	D	d	L	L1	B	A	Dia
DLT-16A	10	6.2	66	32	16	2.5	8.5
DLT-25A	11	7.2	70	35	18	2.8	8.5
DLT-35A	12	8.5	78	37	20	3	10.5
DLT-50A	14	9.5	85	41	23	3.5	10.5
DLT-70S	16	11.5	93	42	26	3.6	12.5
DLT-95A	18	13.5	104	49	26	4.5	12.5
DLT-120A	20	15.1	112	51	30	5	14.5
DLT-150A	22	16.5	117	54	34	5.4	14.5
DLT-185A	25	18.5	125	58	37	5.8	17
DLT-240A	27	20.7	135	60	40	6.5	17
DLT-300A	30	23.5	155	68	46	8	21

## DTL-2-F Bimetal Cable Lugs

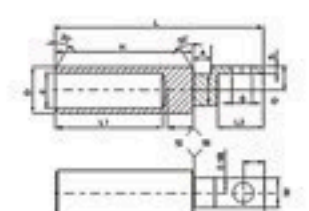

Model	Dimensions(mm)						
	Φ	D	d	L	L1	W	S
DTL-2-10	8.5	16	4.8	88	42	14	4.6
DTL-2-16	8.5	16	5.5	88	42	14	4.6
DTL-2-25	8.5	16	7	88	42	14	4.6
DTL-2-35	8.5	16	8.6	88	42	14	4.6
DTL-2-50	10.5	20	9.5	103	50	17.4	5.6
DTL-2-70	10.5	20	12	103	50	17.4	5.6
DTL-2-95	10.5	20	12.8	103	50	17.4	5.6
DTL-2-120	13	25	14.8	122	60	21.5	7.4
DTL-2-150	13	25	15.8	122	60	21.5	7.4
DTL-2-185	13	32	18.1	131	60	26	7.6
DTL-2-240	13	32	20.1	131	60	26	7.6
DTL-2-300	13	34	22.8	148	64	31.8	8.1

Cable Lugs

Cable Lugs

## DTL-S Bimetal Cable Lugs

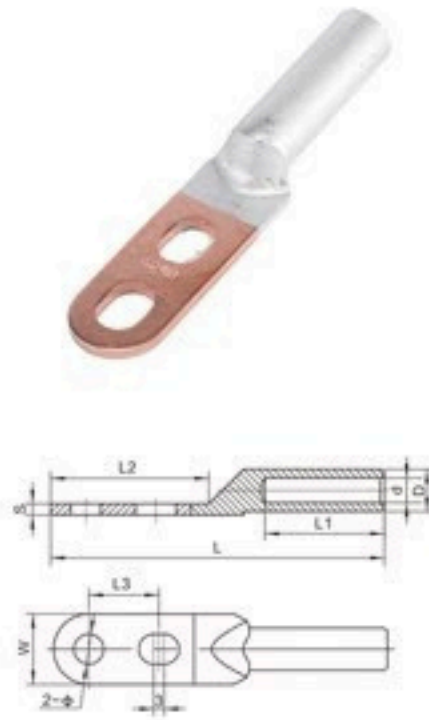

Model	Dimensions(mm)								
	Dia	D	d	L	L1	L2	L3	W	S
DTL-16S	8.4	10	5.5	90	32	45	20	18	3
DTL-25S	8.4	12	7	93.5	38	44	20	18	3.2
DTL-35S	10.5	14	8.5	104	42	48.5	20	20	3.6
DTL-50S	10.5	16	9.5	112	46	50	20	23	4
DTL-70S	12.5	18	12	125	47	59	25	26	4.5
DTL-95S	12.5	21	13	136	53	60	25	28	4.8
DTL-120S	14.5	23	15	145	55	69	30	30	5.5
DTL-150S	14.5	25	16	150	55	70	30	34	6
DTL-185S	14.5	27	18	162	62	76	35	37	6.5
DTL-240S	14.5	30	20	170	65	78	35	40	7
DTL-300S	16.5	34	23	190	72	87	40	45	8.5
DTL-400S	16.5	38	26	195	75	87	40	50	8.5
DTL-500S	21	42	29.5	225	80	110	45	60	9.5

## DL Aluminum Cable Lugs

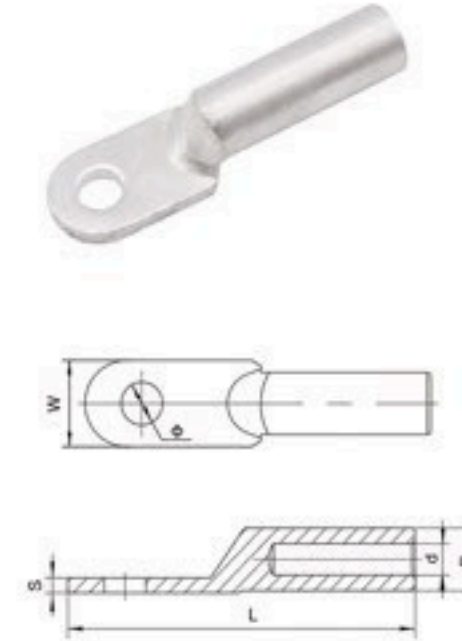

Model	Dimensions(mm)					
	Dia	D	d	L	W	S
DL-16	8.4	10	5.5	70	16	3
DL-25	8.4	12	7	75	18	3.5
DL-35	10.5	14	8.5	85	20	3.5
DL-50	10.5	16	9.5	90	23	4
DL-70	12.5	18	12	102	26	4.5
DL-95	12.5	21	13	112	28	5
DL-120	14.5	23	15	120	30	5.5
DL-150	14.5	25	16	126	34	6
DL-185	16.5	27	18	133	37	6.5
DL-240	16.5	30	20	140	40	7.5
DL-300	21	34	23	165	45	8.5
DL-400	21	38	25	170	52	9.5
DL-500	21	42	29	190	60	10

## GTL Bimetal Cable Tube

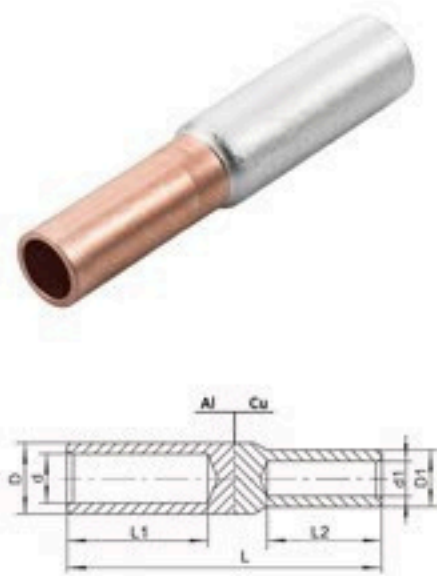

Model	Dimensions(mm)						
	d1	D1	d	D	L1	L2	L
GTL-16	5.5	9	6	10	32	20	69
GTL-25	6	10	7	12	34	23	74
GTL-35	7	11	8.5	13	35	26	80
GTL-50	8.5	12	9.7	15	40	27	85
GTL-70	9.7	14	11.5	18	43	33	95
GTL-95	11.5	16	13.5	20	45	35	101
GTL-120	13.5	19	15	23	50	40	112
GTL-150	15	21	16.5	24	53	40	116
GTL-185	16.5	23	18.5	27	58	44	122
GTL-240	18.5	25	21	30	58	45	128
GTL-300	21	27	23	34	65	52	143
GTL-400	23	30	26.5	38	67	50	155
GTL-500	27	34	29.5	42	75	65	165
GTL-600	29	36	34	54	80	70	180

## DLS Aluminum Cable Lugs

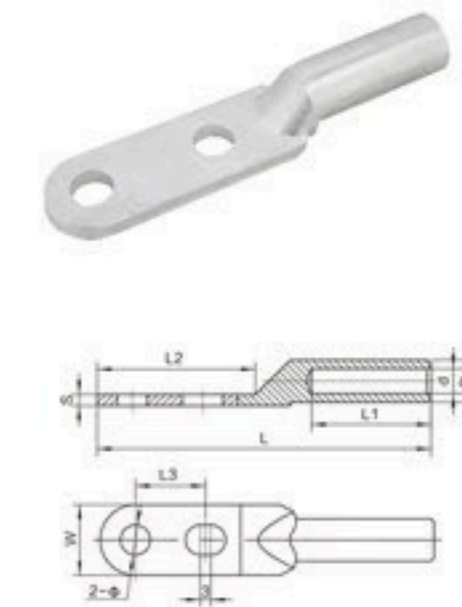

Model	Dimensions(mm)				
	L	L1	B	D	d
DLS-10	110	30	19	12	5.5
DLS-16	112	32	19	12	6
DLS-25	114	34	19	12	7
DLS-35	120	40	19	14	8.5
DLS-50	127	42	23	16	9.5
DLS-70	138	47	26	18	11.5
DLS-95	147	50	28	21	13.5
DLS-120	148	53	30	23	15
DLS-150	156	55	34	25	16.5
DLS-185	165	58	37	27	18.5
DLS-240	170	60	40	30	21
DLS-300	179	65	40	34	23
DLS-400	190	70	50	38	26.5
DLS-500	210	75	50	42	29.5

## DT Copper Cable Lugs

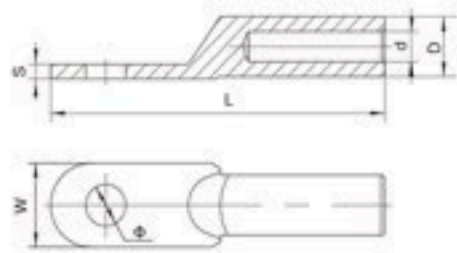

Model	Dimensions(mm)					
	Dia	D	d	L	W	S
DT-10	8.4	9	5.5	66	16	2.2
DT-16	8.4	10	6	67	16	2.5
DT-25	8.4	11	7	70	18	3
DT-35	10.5	12	8.5	79	20	3
DT-50	10.5	14	9.6	87	23	3.5
DT-70	12.5	16	12	95	25	4
DT-95	12.5	18	13	105	28	4.5
DT-120	14.5	20	15	112	30	5
DT-150	14.5	22	16	118	34	5.5
DT-185	16.5	25	18	125	38	6
DT-240	16.5	27	20	136	42	7
DT-300	21	30	23	160	48	8
DT-400	21	34	26	165	54	9
DT-500	21	38	29	190	64	9.5

## DTS 2 Holes Copper Lugs

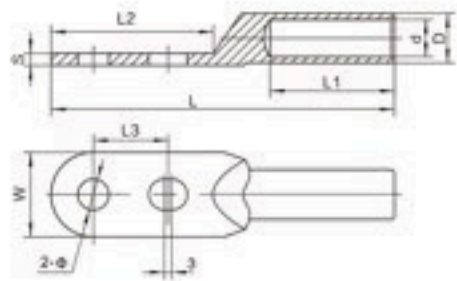

Model	Dimensions(mm)								
	Dia	D	d	L	L1	L2	L3	W	S
DT-10S	8.4	9	5.5	80	30	40	20	16	2.5
DT-16S	8.4	10	6	82	32	40	20	16	2.5
DT-25S	8.4	11	7	86	34	42	20	18	2.5
DT-35S	10.5	12	8.5	93	36	45	20	20	3
DT-50S	10.5	14	9.6	100	40	47	20	23	3
DT-70S	12.5	16	12	115	45	55	25	26	3.5
DT-95S	12.5	18	13	123	48	57	25	28	3.5
DT-120S	14.5	20	15	132	50	63	30	30	4
DT-150S	14.5	22	16	140	54	65	30	34	4.8
DT-185S	14.5	25	18	152	56	73	35	37	5.5
DT-240S	14.5	27	20	160	61	74	35	40	5.7
DT-300S	16.5	30	23	170	65	77	40	45	7
DT-400S	16.5	34	26	178	70	77	40	50	7.5
DT-500S	21	38	29	205	82	90	45	60	9

## SC Cable Lugs

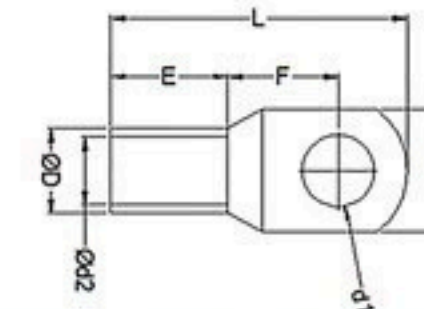

No.	Model	Dimensions(mm)							Thickness (mm)
		d1	d2	D	B	E	F	L	
1	SC1.5-4	4.2	2.2	3.7	8	7	7.4	20	0.75
	SC1.5-5	5.2	2.2	3.7	8	7	7.4	20	0.75
2	SC2.5-4	4.2	2.4	3.9	8	7	7.4	20	0.75
	SC2.5-5	5.2	2.4	3.9	8	7	7.4	20	0.75
	SC2.5-6	6.2	2.4	3.9	8	7	7.4	20	0.75
3	SC4-4	4.2	2.8	4.5	10	7	7.5	20	0.85
	SC4-5	5.2	2.8	4.5	10	7	7.5	20	0.85
	SC4-6	6.2	2.8	4.5	10	7	7.5	20	0.85
4	SC6-5	5.2	4.1	5.5	11	9	9	24	0.70
	SC6-6	6.2	4.1	5.5	11	9	9	24	0.70
	SC6-8	8.2	4.1	5.5	12.5	9	10.2	27	0.70
	SC6-10	10.2	4.1	5.5	14.5	9	10.2	27	0.70
5	SC10-5	5.2	4.8	6.2	11	10	9.0	25	0.70
	SC10-6	6.2	4.8	6.2	11	10	9.0	25	0.70
	SC10-8	8.2	4.8	6.2	12.5	10	10	27	0.70
	SC10-10	10.2	4.8	6.2	14.5	10	11	29	0.70
6	SC16-6	8.2	5.7	7.1	11	12	9.5	28	0.70
	SC16-8	8.2	5.7	7.1	13	12	10.5	30.5	0.70
	SC16-10	10.2	5.7	7.1	15	12	10.5	30.5	0.70
	SC16-12	12.2	6.0	8.0	17	13	12.5	35	1.00
7	SC25-6	6.2	7.1	8.8	11	13	10.5	31	0.85
	SC25-8	8.2	7.1	8.8	13	13	11.5	33	0.85
	SC25-10	10.2	7.1	8.8	15	13	11.5	33	0.85
	SC25-12	12.2	7.1	8.8	17	13	12.5	35	0.85
8	SC35-6	6.5	8.6	10.6	13	15	13	37	1.00
	SC35-8	8.5	8.6	10.6	14	15	13	37	1.00
	SC35-10	10.5	8.6	10.6	16	15	14	38	1.00
	SC35-12	12.5	8.6	10.6	17	15	14	38	1.00
9	SC50-8	8.5	10	12.4	18	17	16	43	1.20
	SC50-10	10.5	10	12.4	18	17	16	43	1.20
	SC50-12	12.5	10	12.4	19	17	16	45	1.20
	SC50-14	14.5	10	12.4	20	17	16	45	1.20

## SC Cable Lugs

No.	Model	Dimensions(mm)							Thickness (mm)
		d1	d2	D	B	E	F	L	
10	SC70-8	8.5	11.8	14.7	21	20	20	52	1.45
	SC70-10	10.5	11.8	14.7	21	20	20	52	1.45
	SC70-12	12.5	11.8	14.7	21	20	20	52	1.45
	SC70-14	14.5	11.8	14.7	21	20	20	52	1.45
11	SC95-8	8.5	14.2	17.4	25	23	22	58	1.60
	SC95-10	10.5	14.2	17.4	25	23	22	58	1.60
	SC95-12	12.5	14.2	17.4	25	23	22	58	1.60
	SC95-14	14.5	14.2	17.4	25	23	22	58	1.60
	SC95-16	16.5	14.2	17.4	25	23	22	58	1.60
12	SC120-8	8.5	15.8	19.4	28	24	25	63	1.80
	SC120-10	10.5	15.8	19.4	28	24	25	63	1.80
	SC120-12	12.5	15.8	19.4	28	24	25	63	1.80
	SC120-14	14.5	15.8	19.4	28	24	25	63	1.80
	SC120-16	16.5	15.8	19.4	28	24	25	63	1.80
13	SC150-10	10.5	16.5	20.5	30	26	27	70	2.00
	SC150-12	12.5	16.5	20.5	30	26	27	70	2.00
	SC150-14	14.5	16.5	20.5	30	26	27	70	2.00
	SC150-16	16.5	16.5	20.5	30	26	27	70	2.00
14	SC185-10	10.5	18.8	23	34	32	27	77	2.10
	SC185-12	12.5	18.8	23	34	32	27	77	2.10
	SC185-14	14.5	18.8	23	34	32	27	77	2.10
	SC185-16	16.5	18.8	23	34	32	27	77	2.10
15	SC240-12	12.5	21.4	26	38	38	31	90	2.30
	SC240-14	14.5	21.4	26	38	38	31	90	2.30
	SC240-16	16.5	21.4	26	38	38	31	90	2.30
16	SC300-12	13	24.6	30	43	42	33	100	2.70
	SC300-16	17	24.6	30	43	42	33	100	2.70
	SC300-20	21	24.6	30	43	42	33	100	2.70
17	SC400-12	13	26.9	34	53	44	43	110	3.55
	SC400-16	17	26.9	34	53	44	43	110	3.55
	SC400-20	21	26.9	34	53	44	43	110	3.55
18	SC500-12	13	30	37.5	56	48	49	120	3.75
	SC500-16	17	30	37.5	56	48	49	120	3.75
	SC500-20	21	30	37.5	56	48	49	120	3.75
19	SC630-12	13	36	44	65	55	57	140	4.00
	SC630-16	17	36	44	65	55	57	140	4.00
	SC630-20	21	36	44	65	55	57	140	4.00

## GL Aluminum Connecting Tube (passing-through)



Model	Dimensions(mm)		
	D	d	L
GL-10	10	5.5	55
GL-16	10	5.5	65
GL-25	12	7	70
GL-35	14	8.5	75
GL-50	16	9.5	80
GL-70	18	12	90
GL-95	21	13	95
GL-120	23	15	100
GL-150	25	16	105
GL-185	27	18	110
GL-240	30	20	120
GL-300	34	23	130
GL-400	36	26	140
GL-500	42	29	150
GL-630	54	34	170

## GT Copper Connecting Tube (passing-through)



Model	Dimensions(mm)		
	D	d	L
GT-10	8	5	50
GT-16	9	6	56
GT-25	10	7	60
GT-35	12	8.5	64
GT-50	14	10	72
GT-70	16	12	78
GT-95	18	13	85
GT-120	20	15	90
GT-150	22	16	94
GT-185	25	18	100
GT-240	27	20	110
GT-300	31	24	120
GT-400	34	26	135
GT-500	38	30	150
GT-630	45	35	170

## GLM Aluminum Connecting Tube (oil seal)



Model	Dimensions(mm)			
	D	d	L	L1
GLM-10	10	5.5	65	31
GLM-16	10	5.5	70	33.5
GLM-25	12	7	75	36
GLM-35	14	8.5	85	41
GLM-50	16	9.5	95	46
GLM-70	18	12	105	51
GLM-95	21	13	110	52.5
GLM-120	23	15	115	55
GLM-150	25	16	120	57.5
GLM-185	27	18	125	60
GLM-240	30	20	130	62.5
GLM-300	34	23	140	67.5
GLM-400	38	26	150	72.5
GLM-500	42	29	160	77.5
GLM-630	54	34	170	82.5

## GTU Copper Cable Lugs



Model	Dimensions(mm)			Thickness (mm)
	d1	D	L	
GTU1.5	2.7	3.7	18.0	0.5
GTU2.5	2.9	3.9	18.0	0.5
GTU4	3.2	4.5	20.0	0.65
GTU6	4.1	5.5	24.0	0.7
GTU10	4.6	6.2	25.0	0.8
GTU16	5.5	7.1	29.0	0.8
GTU25	7.0	8.8	29.0	0.9
GTU35	8.6	10.6	35.0	1.0
GTU50	10.0	12.4	35.0	1.2
GTU70	11.9	14.7	45.0	1.4
GTU95	14.2	17.4	47.0	1.6
GTU120	15.8	19.4	52.0	1.8
GTU150	16.7	20.5	59.0	1.9
GTU185	19.1	23.5	65.0	2.2
GTU240	21.4	26.0	75.0	2.3
GTU300	24.6	30.0	90.0	2.7
GTU400	27.4	34.0	105.0	3.3
GTU500	30.8	38.0	105.0	3.6
GTU630	36.0	44.0	120.0	4.0

## GTM Copper Connecting Tube (oil seal)



Model	Dimensions(mm)			
	D	d	L	L1
GTM-10	9	5	62	29.5
GTM-16	10	6	65	31
GTM-25	11	7	70	33.5
GTM-35	12	8.5	75	36
GTM-50	14	9.5	80	38.5
GTM-70	16	12	90	43.5
GTM-95	18	13	95	45
GTM-120	20	15	100	47.5
GTM-150	22	16	105	50
GTM-185	25	18	110	52.5
GTM-240	27	20	120	57.5
GTM-300	31	23	130	62.5
GTM-400	34	26	140	67.5
GTM-500	38	30	155	75
GTM-630	45	35	170	82.5

## CCT Copper Cable Tube

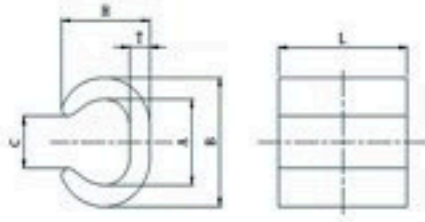

Model	Cable Size (mm <sup>2</sup> )	Dimensions(mm)					
		H1	H2	W	L	T	C
CCT-10	7.5-11	9.5	6.3	6.2	12	1.6	4
CCT-16	11.5-16	11.8	7.8	7.3	13	2	5
CCT-20	14-20	12.8	8.6	9.7	13	2.9	5.4
CCT-26	21-26	14.7	10.2	10.9	16	3.2	6.5
CCT-44	27-44	19	12.4	14.4	20	4	8.5
CCT-60	45-60	21	15.4	15.1	22	4	9.7
CCT-76	61-76	24.4	17.3	17.6	22	5	10.8
CCT-98	77-98	27.8	20.8	18.1	25	5	12.8
CCT-122	99-122	29.8	21.1	21.2	26	5.5	13.5
CCT-154	123-154	34	25.7	24.2	28	6	17
CCT-190	155-190	37	28.5	25.4	35	6	17.4
CCT-240	191-240	40	30.2	28.5	40	7	19
CCT-288	241-288	44.5	34.7	31.1	45	7	22.3
CCT-365	289-365	47.5	37.7	34	50	7	24.8
CCT-450	366-450	57	42.5	41	60	10	26
CCT-560	451-560	62	46	45	65	11	31
CCT-700	561-700	68	52	49.5	70	12	34

## TJ Copper Cable Lugs

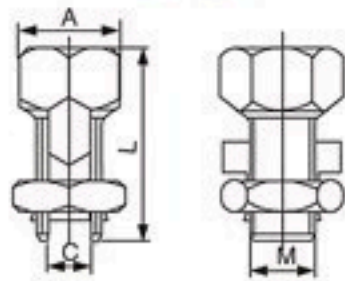

Model	Dimensions(mm)			
	L	M	C	A
T/J-16	20	M17X2.5	6	18
T/J-25	17	M19X2.5	7	20
T/J-35	35	M21X2.5	7	22
T/J-50-70	42	M23X2.5	11	24
T/J-95/120	45	M25X2.5	14	26
T/J-150-185	60	M29X2.5	17	30
T/J-210-240	72	M31X2.5	20	32

Make Electrical Connection Easier and More Safe

## PLASTIC BOX

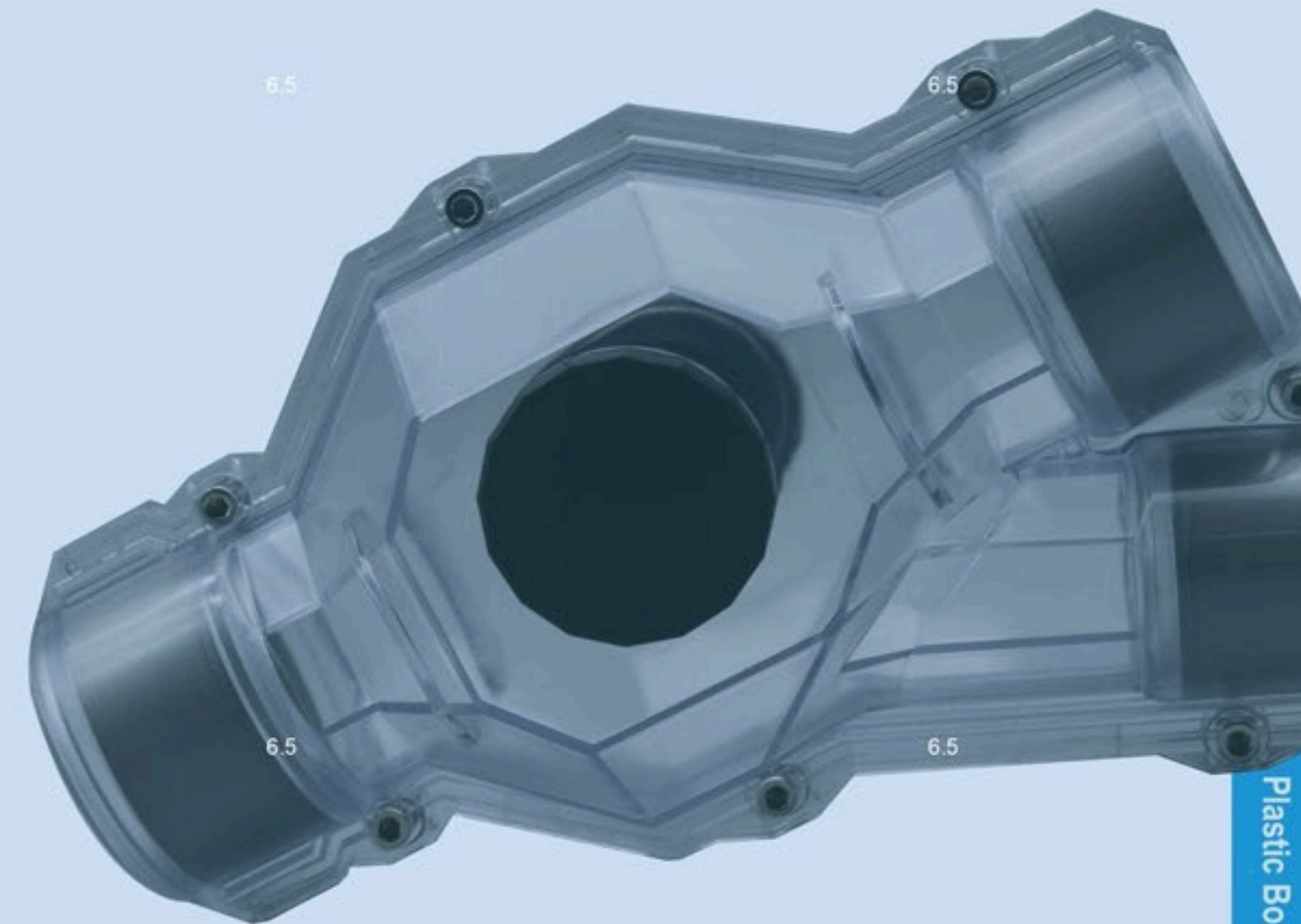

## KW-BOX Resin Joint Kits



Model	Cable Insulation O.D Range (mm)	Conductor Section (mm <sup>2</sup> )			Specification (mm)	Resin Weight (g)
		Main Line		Branch Line		
		armored cable	unarmored cable			
BOX-0	Φ8-15	16-25	16-35	2.5-10	150x38x32	30
BOX-1	Φ8-16	1.5-25	1.5-50	1.5-10	123x118x124	116
BOX-2	Φ8-19	16-50	4-95	4-95	78x70x78	330

## KW-A Straight Resin Joint Kits



Model	Cable Insulation O.D Range (mm)	Max Conductor Section (mm <sup>2</sup> )		Material	Specification (mm)	Resin Weight (g)
		unarmored cable	armored cable			
KW-A0	1-17	5x4	5x2.5	PC	150x31x35	80
KW-A1	8-26	5x16	5x10	PC	185x40x45	175
KW-A2	14-32	5x25	5x16	PC	270x55x55	400
KW-A3	23-39	5x50	5x25	PC	355x65x60	700
KW-A4	28-50	5x95	5x70	PC	400x90x75	1350
KW-A5	45-70	5x185	5x150	PC	510x160x120	5430
KW-A6	35-65	5x150	5x120	PC	530x120x125	3000
KW-A7	45-80	5x240	5x240	PC	700x160x180	7000

## KW-AB Branch Resin Joint Kits

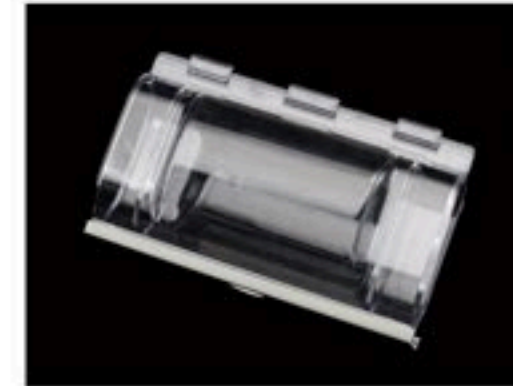

Item NO.	Cable Insulation O.D Range(mm)		Max Conductor Section (mm <sup>2</sup> )		Material	Specification (mm)	Resin Weight (g)
	Main	Branch	Main Line	Branch Line			
KW-AB111	15	15	4x1.5-6	4x1.5-4	PC	175x75x40	160
KW-AB112	29	22	4x16-25(35)	4x6-16	PC	175x110x76	600
KW-AB113	29	22	4x16-25(35)	4x6-16	PC	300x110x76	1000
KW-AB114	35	25	4x35-70(95)	4x6-25	PC	400x125x100	2500
KW-AB115	55	38	4x95-150	4x6-70	PC	510x160x120	5000

## Application



## KWAB-T Branch Resin Joint Kits



Item NO.	Cable Insulation O.D Range(mm)		Max Conductor Section (mm <sup>2</sup> )		Material	Specification (mm)	Resin Weight (g)
	Main	Branch	Main Line	Branch Line			
	KWAB-T1	38	30	4x6-50			
KWAB-T2	38	30	4x6-50	4x1.5-25	PP	235x130x95	1300
KWAB-T3	55	36	4x95-240	4x6-150	PP	295x140x180	2000

## Application



## KW-XY Branch Resin Joint Kits



KW-XY-1



KW-XY-2

Item NO.	Cable Insulation O.D Range (mm)		Max Conductor Section (mm <sup>2</sup> )		Specification (mm)	Resin Weight (g)	Material
	Main	Branch	Main Line	Branch Line			
KW-XY-1	Φ8-16	Φ8-16	≤4x4	≤4x4	187×53×39	175	PC
KW-XY-2	Φ13-22	Φ8-20	≤4x16	≤4x6	143×76×63	210	PC

## Installation

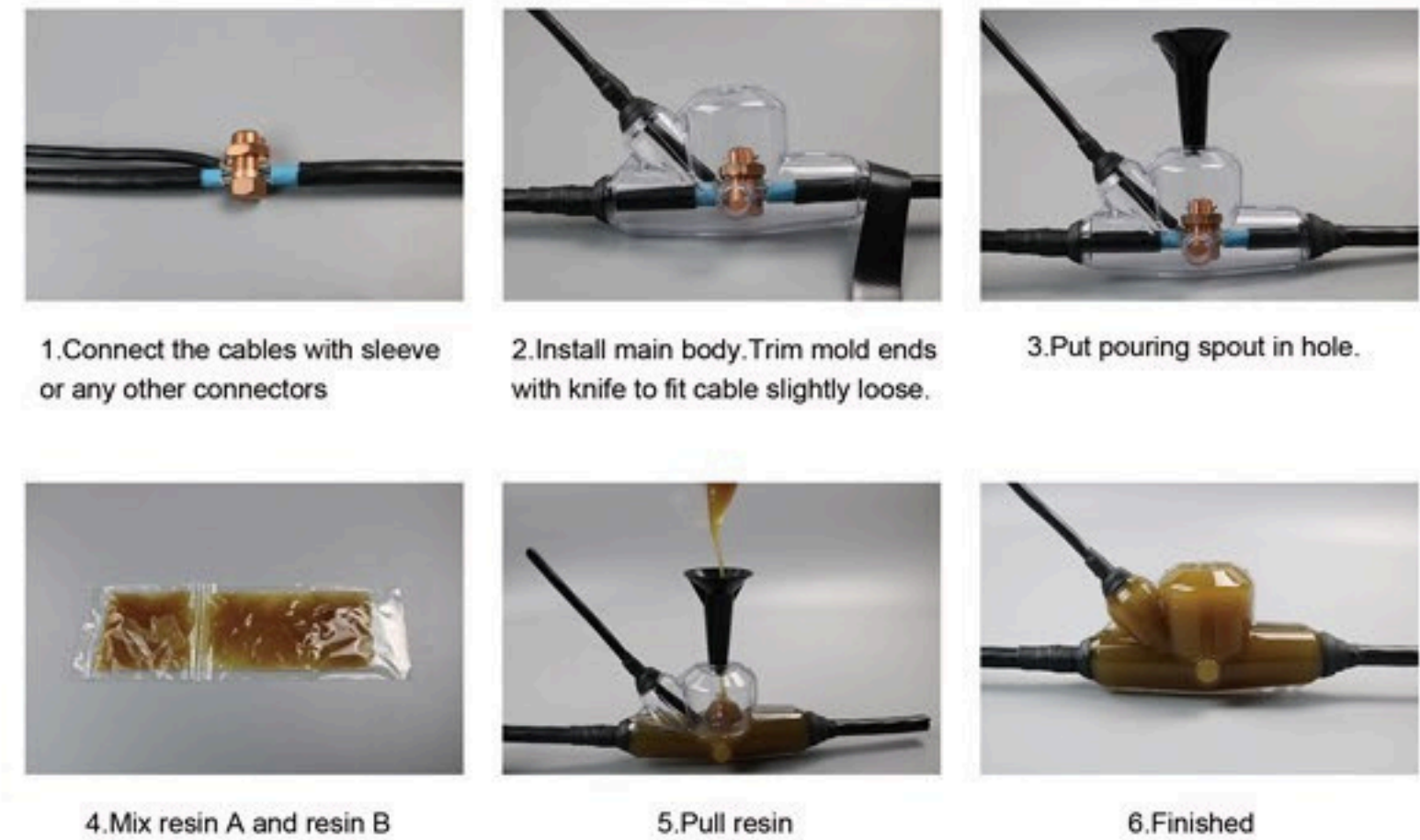

## KW-Y Branch Resin Joint Kits



KW-Y1



KW-Y2



KW-Y3

Item NO.	Cable Insulation O.D Range (mm)		Max Conductor Section (mm <sup>2</sup> )		Specification (mm)	Resin Weight (g)	Material
	Main	Branch	Main Line	Branch Line			
KW-Y1	Φ10-28	Φ5-18	≤4x25	≤4x10	176x120x105	500	PC
KW-Y2	Φ20-40	Φ8-30	≤4x70	≤4x25	250x142x111	1000	PC
KW-Y3	Φ20-40	Φ8-30	≤4x95	≤4x95	350x142x111	2000	PC
KW-Y4	Φ30-65	Φ20-56	≤4x240	≤4x240	485x220x180	6000	PC

Make Electrical Connection Easier and More Safe

## Arrester & Insulator



Arrester & Insulator

## Composite Tension & Suspension Insulator

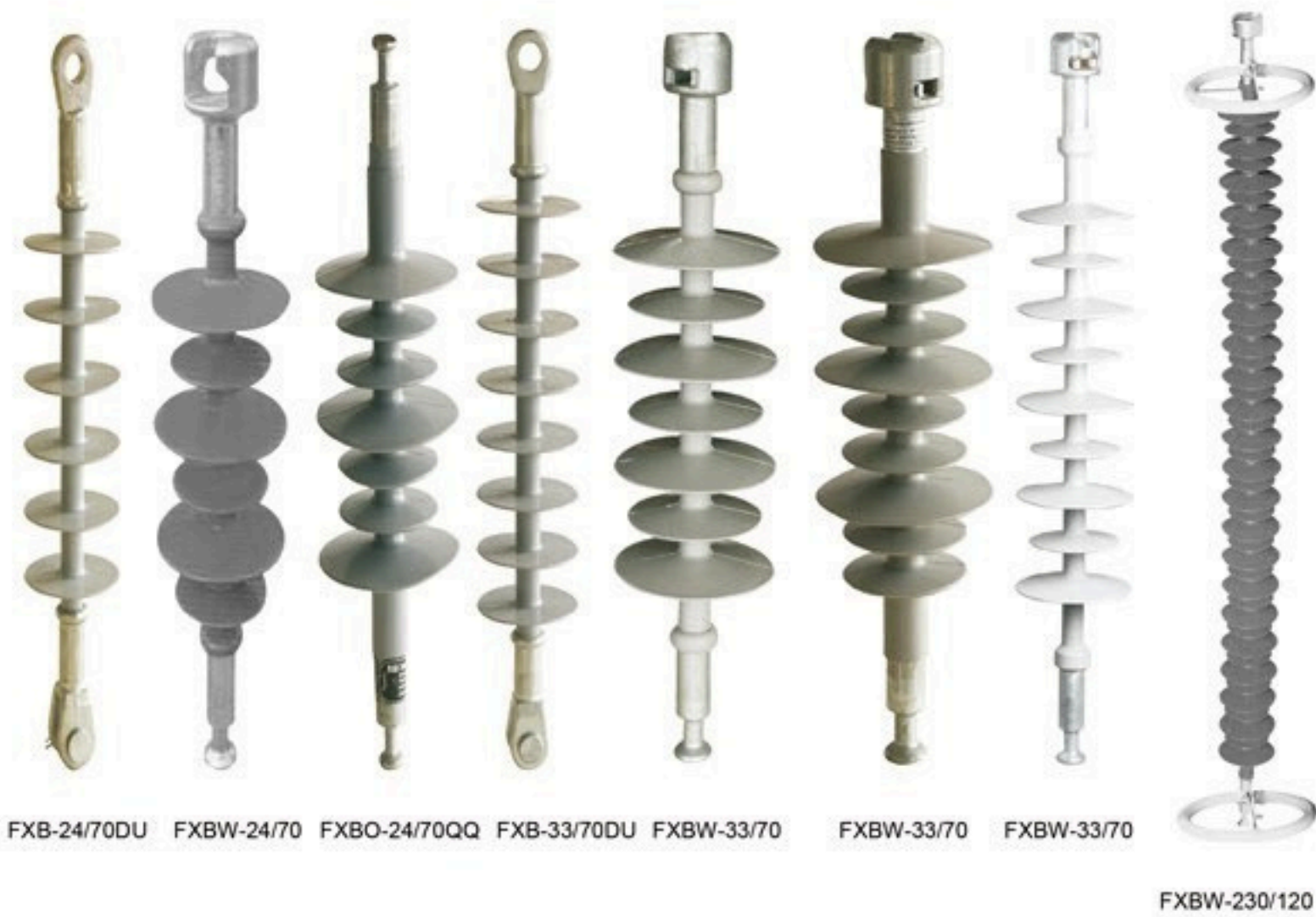
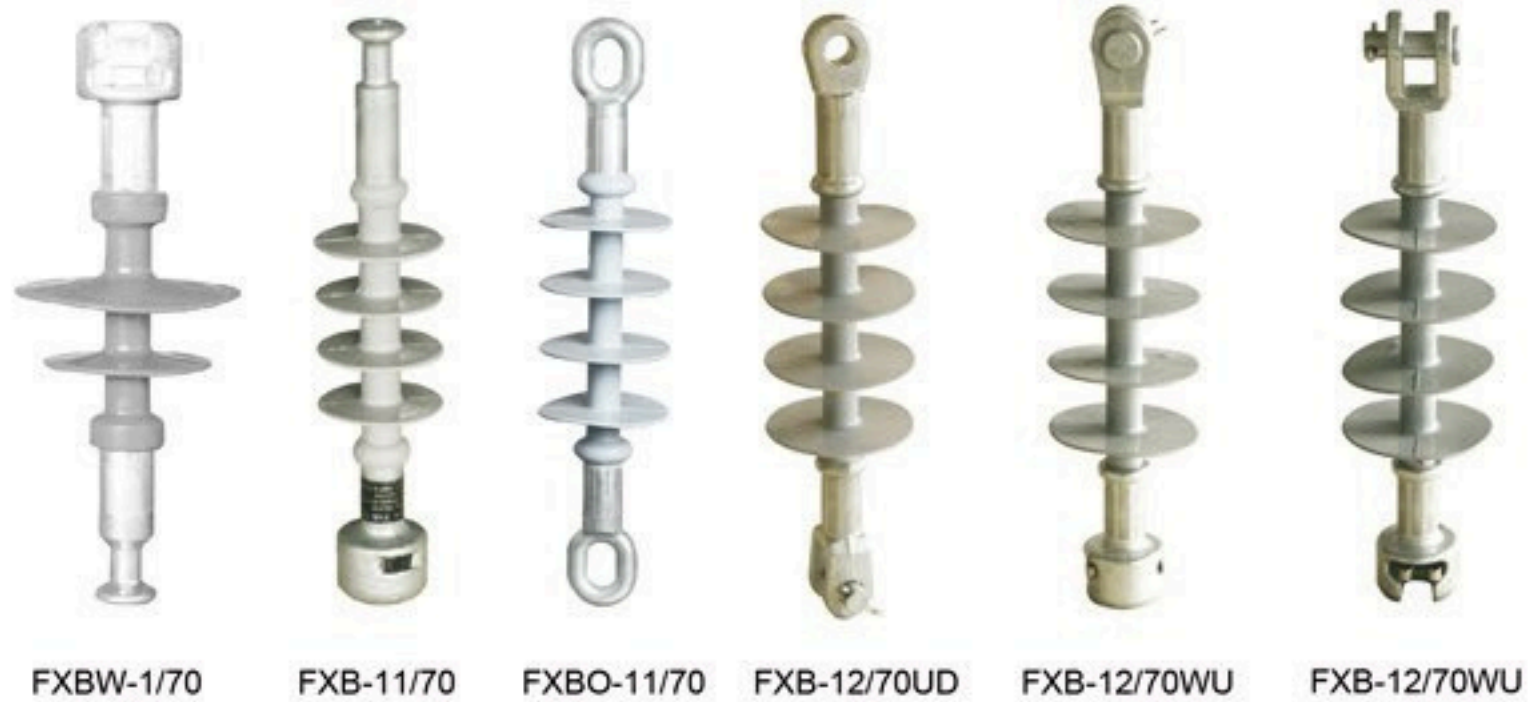

## Surge Arrester

The distribution class surge arrester is the most common type of protective devices used on power systems today. The primary function of the distribution surge arrester is to protect the insulation of distribution class oil-filled transformers.

KEYI supplies both polymer-housed and porcelain-housed surge arresters up to 48KV.

### Polymer Housed Surge Arrester Photo Reference (3 Sheds to 22 Sheds)

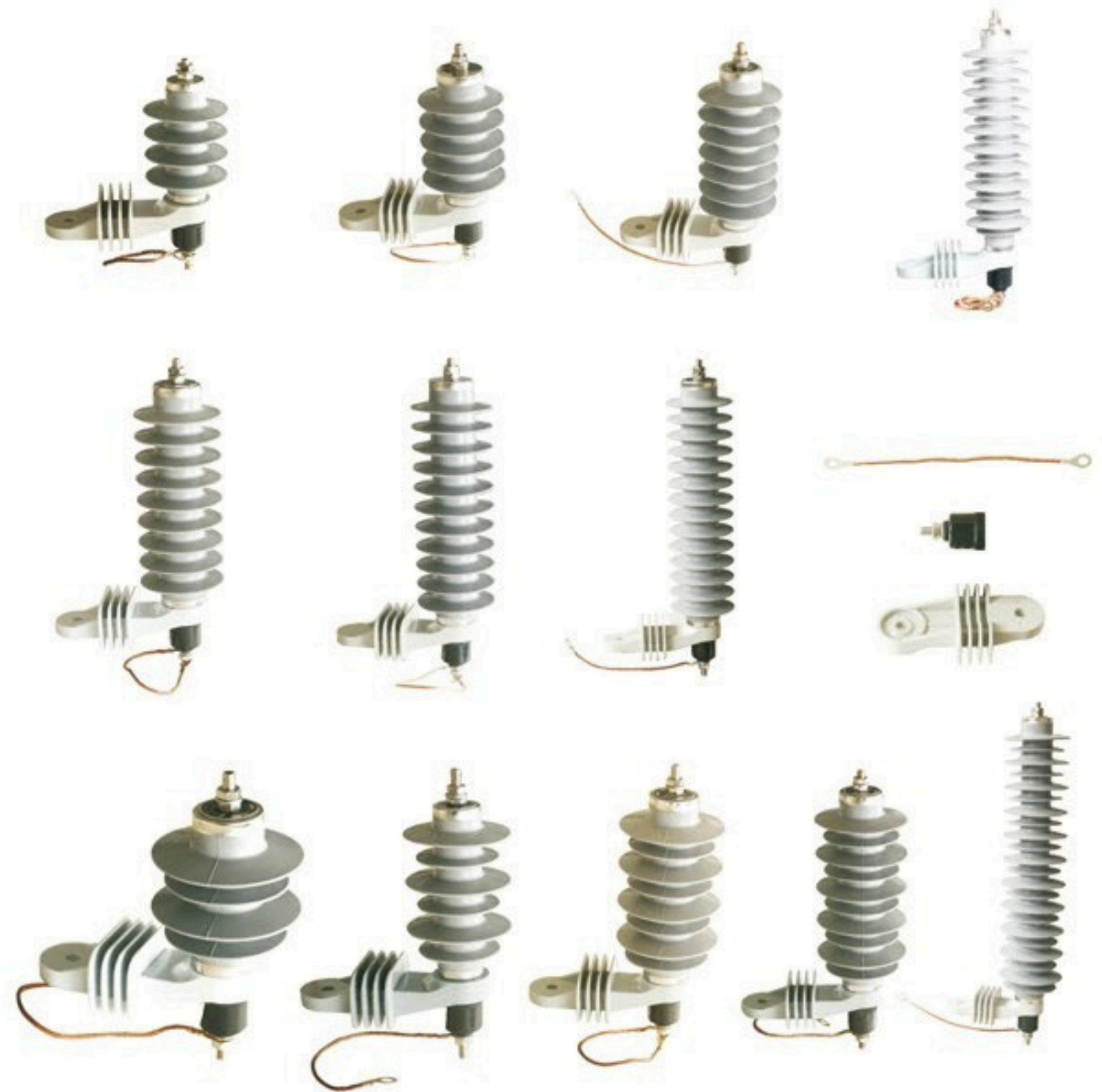

## Link Fitting



BD



L Type



PD



PS



PT



Q



W



WS



U



U-Bolt



Z



ZH